

Wet Location Profile Wrap: WL-C-LED

Sealed 4' Linear High Efficiency LED Surface C-Profile Wrap

- **DLC Listing available for some configurations**
- **IP55 Rated**
- **ETL Listed for Wet Locations**
- **Several mounting options for surface or suspended installation**
- **B.A.A. Compliant & Made in the USA by a Family Owned US Corporation**
- **End to end row mounting optional**



Not all product variations listed on this page are DLC qualified.
Visit <https://www.designlights.org/gli> to confirm qualification.

DISCLAIMER: Although KURTZON has prepared the information contained in this document with all due care, KURTZON does not warrant or represent that the information is free from errors or omission. While the information is considered to be true and correct at the date of publication, changes in circumstances after the time of publication may impact on the accuracy of the information. The information may change without notice and KURTZON is not in any way liable for the accuracy of any information printed and stored or in any way interpreted or used.

ORDERING GUIDE

Series	Lens Type	Material	Series	Row Qty.	LED Type	CCT/CRI	Voltage	Options
WL			40		LEDR			
Series	Lens Type	Material	Size	Row Qty.	LED Type	CCT/CRI	Voltage	Options
WL	C Frosted Acrylic	1 White CRS Ext. Hsg. & White CRS Int.	40: 4' Housing	2	LEDR	83 CRI:	120V	FC Fuse & Holder (One Supplied Per Circuit)
	LPC Clear Linear Prismatic Poly	3 Polished 304 SS ext. & 304 SS int.		4		830 3000K	277V	2/ED Two Drivers/Two Circuits
	FPC Frosted Linear Prismatic Poly	4 White Alum Ext. & White CRS Int.				835 3500K	UNV	EDL -40F Electronic Driver
						840 4000K	347V*	EM10 10W Integral LED EM (Specify Input Voltage)
						850 5000K		CRM Continuous Row Mounting
						90+ CRI:		SW Wet Location Hub Supplied (not installed)
						935 3500K		WHT White Finished Door & HSG
						940 4000K		PMB (2) Pendant Mount Brackets (Pendants or Chains by Others)
						950 5000K		CMB (2) Corner Mount Brackets
								AMB (2) Adjustable Mount Brackets
								PxL Programmed to User Specified Lumen Value.
								PxW Programmed to User Specified Wattage Value.
								10KV 10KV Parallel Surge Protection (One Supplied Per Circuit)
								GTD Generator Transfer Device
								WHIP Must Specify Length and Wire Qty
								OCC Occupancy Sensor (Must Specify Type)
								AMW Anti-Microbial White Powdercoat

Ordering Notes, If Applicable

Wet Location C Profile Wrap: WL-C-LED

Sealed 4' Linear High Efficiency LED Surface C-Profile Wrap

SPECIFICATIONS

HOUSING: Double channel housing of 20Ga 1008 Cold Rolled Steel, 20Ga 304 Stainless Steel, or .040" 3003 Aluminum construction.

END CAPS: Precision stamped 20Ga 304 Stainless Steel end caps secured to housing with captive stainless steel flush head screws. SW Option provides a 3 piece conduit hub/ring/plug assembly installed in the endcap.

GASKETS: Closed cell 100% pure neoprene gasketing. Resists aging, grease and solvents.

OPTICS: All lensing is extruded from a nominal 1/8" plastic material. Available in frosted acrylic, Clear Polycarbonate with linear ribs, or Clear Polycarbonate with a frosted inlay.

LEDs: Commercially available in a wide variety of Color Temperature (CCT), FLUX, and CRI. Highly efficient and consistent color maintained to 3 SDMC for color critical applications. B50/L70 and compliant with Zhaga recognized hole patterns. Consult factory for LED options or configurations not listed below

DRIVERS: Standard Universal Voltage Class 2 drivers are 0-10v Dimmable to 1% for most LED configurations. They come with at least 2.5Kv surge protection, have less than 10% THD at max load, Ballast Factor Greater than .95 and are programmable to match specific lumen or wattage requirements. Drivers with higher input voltage ratings are available, consult factory for driver specifications

REFLECTOR: Die formed metal with high reflectance white polyester powder coat finish. Typical reflectivity 92%.

INSTALLATION: Suitable for wet location installation under covered ceilings only. Luminaire is provided with four 5/16" debossed holes for mounting. Power is brought in though 1/2" flattened conduit K.O. located on the bottom of luminaire. Power can also be brought through the end of the luminaire with SW option selected. Suitable for thru wiring.

ROWS: Joiner bands provided for continuous row mounting (See Option: CRM). Please specify number of fixtures in each run.

FINISH: Stainless steel housings are satin polished unless WHT or AMW options are selected. All other materials are provided with gloss high reflectance white polyester powder coat with 1000hr salt spray test per ASTM B117. AMW option provides a white anti-microbial polyester powder coat to all exposed surfaces.

LISTINGS: IP55 rated for dust and water ingress. ETL listed per UL_1598 for wet locations. Electrical components covered under manufacturers warranty, the remaining fixture is covered by a 10 year warranty. This product is Buy American Act (B.A.A.) compliant.

PRODUCT DRAWINGS

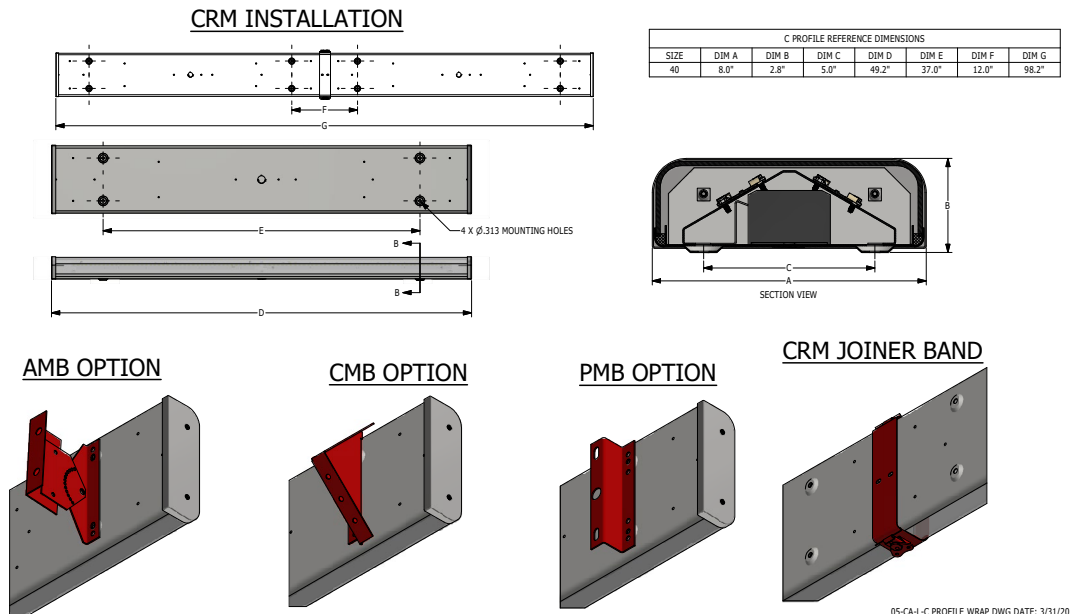

Wet Location C Profile Wrap: WL-C-LED

Sealed 4' Linear High Efficiency LED Surface C-Profile Wrap

ENERGY DATA

"C" PROFILE LED WRAP (APPROX ¹ LUMENS DELIVERED)											
LENS TYPE	ENCLOSURE SIZE	LED SELECTION	STANDARD DIMMING	83 CRI (3000K - 5000K)				90 CRI (3500K - 4000K)			
				LUMENS	WATTS ²	EFFICACY ³	MAX AMB TEMP ⁴	LUMENS	WATTS ²	EFFICACY ³	MAX AMB TEMP ⁴
C	40	2LEDR	0-10V 1%	8,171	56	146	40°C (104°F)	7,893	56	141	40°C (104°F)
FPC	40	2LEDR	0-10V 1%	6,150	56	110	40°C (104°F)	5,941	56	106	40°C (104°F)
LPC	40	2LEDR	0-10V 1%	7,700	56	138	40°C (104°F)	7,438	56	133	40°C (104°F)
C	40	4LEDR	0-10V 1%	14,285	112	128	40°C (104°F)	13,799	112	123	40°C (104°F)
FPC	40	4LEDR	0-10V 1%	10,800	112	96	40°C (104°F)	10,433	112	93	40°C (104°F)
LPC	40	4LEDR	0-10V 1%	13,521	112	121	40°C (104°F)	13,061	112	117	40°C (104°F)

- ¹ DELIVERED LUMEN DATA IS EXTRAPOLATED FROM MEASURED DATA @25C WITH NO EXTRA OPTIONS. VARIANCES WILL OCCUR WHEN OTHER SELECTIONS ARE MADE
- ² WATTAGE IS MEASURED WITH 4000K SELECTION @ 120vAC AND Tambient = 25C. WATTAGES MAY VARY WITH ALTERNATE CONFIGURATIONS
- ³ EFFICACY CALCULATED USING 4000K CCT DATA.
- ⁴ MAX AMBIENT TEMP RATING. TEMP RATING MAY VARY WITH ALTERNATE SPECIFIED DRIVERS OR ANY NON STANDARD SELECTION

PHOTOMETRICS

C Optic

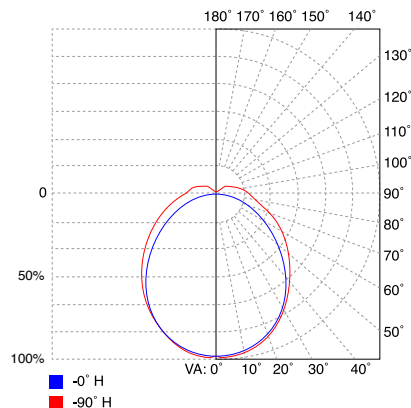

LPC Optic

