

Medical Patient Room Troffers

6"x24" & 6"x48" Recessed LED Luminaire

- **For Patient Rooms**
- **2-Way Switching for Exam/Ambient Modes**
- **Available with Low Voltage Controller Setup**
- **Frosted Acrylic Lens for glare reduction**
- **0-10v Dimming to 1% standard**



DISCLAIMER: Although KURTZON has prepared the information contained in this document with all due care, KURTZON does not warrant or represent that the information is free from errors or omission. While the information is considered to be true and correct at the date of publication, changes in circumstances after the time of publication may impact on the accuracy of the information. The information may change without notice and KURTZON is not in any way liable for the accuracy of any information printed and stored or in any way interpreted or used.

ORDERING GUIDE

Series	Installation Type	Material	Size	Source	CCT	Voltage	Options
ML							
ML	F/PR: Flange G/PR: Grid	1: White CRS Hsg.	6x48: 6" x 48" Housing 6x24: 6" x 24" Housing	2/LEDR 3/LEDR	80 CRI: 830 = 3000K CCT 835 = 3500K CCT 840 = 4000K CCT 850 = 5000K CCT 90 CRI: 935 = 3500K CCT 940 = 4000K CCT	120V 277V UNV 347V*	FC: Fuse & Holder (One Supplied Per Circuit) RFI: Providing with RF Filter for each circuit EM10: 10W Integral LED EM LVC: Low Voltage Controller 10KV: 10KV Surge protection (1 per circuit) Note: Two circuits, ambient and exam, are provided as standard.

Medical Patient Room Troffers

6"x24" & 6"x48" Recessed LED Luminaire

SPECIFICATIONS

HOUSING: Formed and Welded 20Ga Steel housing. Flange housing is provided with factory installed flange kit.

REFLECTOR: Full reflector panel designed to enhance asymmetric distribution. High reflectance white powder coat finished (minimum reflectivity 92%).

LENS: One piece frosted linear regressed acrylic lens provided high lamp hiding.

LEDS: Commercially available in a wide variety of Color Temperature (CCT), FLUX, and CRI. Highly efficient and consistent color maintained to 3 SDMC for color critical applications. B50/L70 and compliant with Zhaga recognized hole patterns. Consult factory for LED options or configurations not listed below.

DRIVERS: Standard Universal Voltage Class 2 drivers are 0-10v Dimmable to 1%. They come with at least 2.5Kv surge protection, have less than 10% THD at max load, Ballast Factor Greater than .95 and are programmable to match specific lumen or wattage requirements. Drivers with higher input voltage ratings are available, consult factory for driver specifications.

INSTALL GRID: Adjustable Zee-brackets provide even support. See options for integrated seismic support brackets. Wireway access is through a removable plate containing two silicone sealed knockouts. Note: This fixture is not for plaster or drywall ceilings.

INSTALL FLANGE: Two adjustable yoke mounting brackets provide even support. Wireway access is through a removable plate containing two silicone sealed knockouts. Note: This fixture is not for T-Bar Grid ceilings.

FINISH: White polyester powder coated over multi-stage pretreatment. See options for DuPont Alesta™ using Agion® silver ion antimicrobial powder coat finished housings.

LISTINGS: ETL listed per UL_1598 for damp locations. Drivers and LEDs are covered by a 5 year warranty, the remaining fixture is covered by a 10 year warranty.

PRODUCT DRAWINGS

6x48 PATIENT ROOM				
SIZE	DIM A	DIM B	DIM C	DIM D
6 x 48	47.68"	4.30"	46.06"	5.68"
6 x 24	23.68"	4.30"	22.50"	5.68"

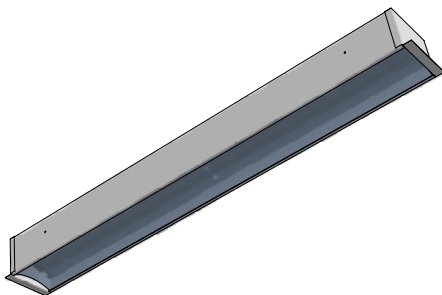
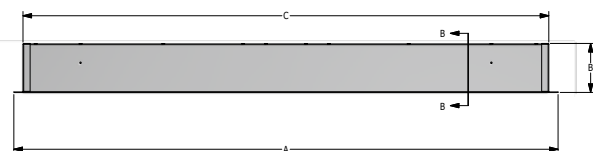
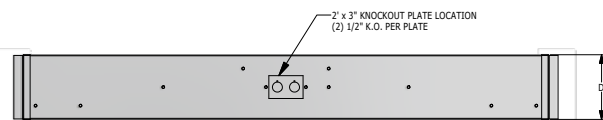

14-AA-L-6x48 PATIENT ROOM DWG DATE: 12/20/2018

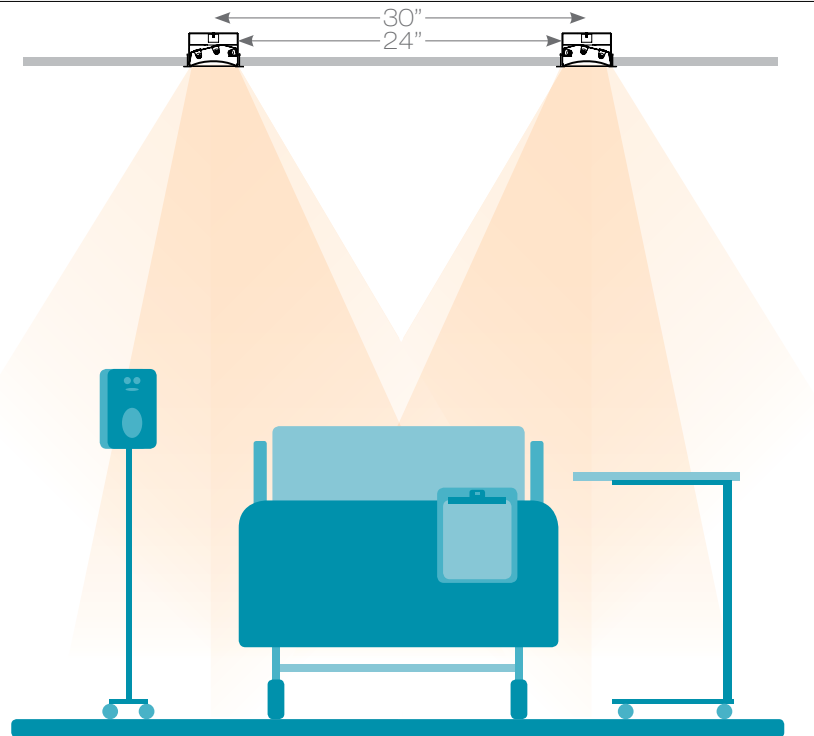

Two recessed asymmetric distribution luminaires installed at 30 inches on center provide examination level illumination across the full bed surface.

Medical Patient Room Troffers

6"x24" & 6"x48" Recessed LED Luminaire

ENERGY DATA

LED PATIENT ROOM TROFFER WITH EXAM/AMBIENT MODE									
ENCLOSURE SIZE	LIGHT PACKAGE	80 CRI			90 CRI			DIMMING AVAILABILITY	MAX AMBIENT TEMP ⁴ (°C)
		LUMENS ¹	WATTAGE ²	EFFICACY ³	LUMENS ¹	WATTAGE ²	EFFICACY ³		
6x48	1 LED AMBIENT	2,016	29	70	1,734	29	60	0-10V 1%	40°C (104°F)
6x48	1 LED EXAM + 1 LED AMBIENT	5,300	59	90	4,558	59	77	0-10V 1%	40°C (104°F)
6x48	2 LED EXAM + 1 LED AMBIENT	8,621	84	103	7,414	84	88	0-10V 1%	40°C (104°F)
6x24	1 LED AMBIENT	1,000	15	67	860	15	57	0-10V 1%	40°C (104°F)
6x24	1 LED EXAM + 1 LED AMBIENT	2,600	30	87	2,236	30	75	0-10V 1%	40°C (104°F)
6x24	2 LED EXAM + 1 LED AMBIENT	4,300	44	98	3,698	44	84	0-10V 1%	40°C (104°F)
ALL	EM10 ⁵	900-1030	4	NA	770-880	4	NA	NA	40°C (104°F)

- ¹ DELIVERED LUMEN DATA IS EXTRAPOLATED FROM MEASURED DATA @25C WITH NO EXTRA OPTIONS. VARIANCES WILL OCCUR WHEN OTHER SELECTIONS ARE MADE
- ² WATTAGE IS MEASURED WITH LED 840 SELECTION @ 120vAC AND Tambient = 25C. WATTAGES WILL VARY AND INCREASE WHEN ALTERNATE OPTOINS ARE SELECTED
- ³ EFFICACY CALCULATED USING 80 CRI 4000K CCT DATA.
- ⁴ MAX TEMP RATING IS WITH NO OTHER OPTIONS SELECTED.
- ⁵ INITIAL LUMEN VALUE IN EMERGENCY MODE CALCULATED WITH LEAST EFFICIENT CONFIGURATION BY (10W)*(NORMAL LUMENS / NORMAL WATTS) AVAILABLE 48" ONLY

PHOTOMETRICS

ML-G/PR-1-6X48-3/LEDR840-UNV - (AMBIENT MODE)

Report No: 19802.0
 Total Lumens: 2,016
 Wattage: 28.72
 Efficacy: 81.8 (Lumens Per Watt)
 Fixture Size: 4'
 Key:
 --- 0
 - - - 45
 ——— 90

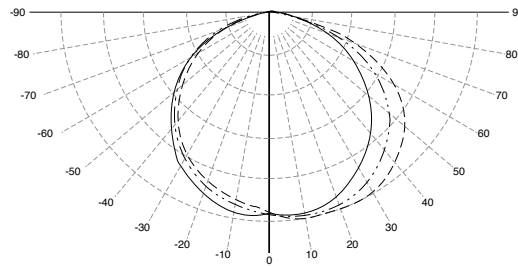

ML-G/PR-1-6X48-3/LEDR840-UNV - (EXAM MODE)

Report No: 19801.0
 Total Lumens: 8621
 Wattage: 84.000
 Efficacy: 102.6 (Lumens Per Watt)
 Fixture Size: 4'
 Key:
 --- 0
 - - - 45
 ——— 90

