

# Medical Patient Room Troffers: ML-GFPR-LED

6"x24" & 6"x48" LED Recessed Luminaire

- **For Patient Rooms**
- **2-Way Switching for Exam/Ambient Modes**
- **Available with Low Voltage Controller Setup**
- **Frosted Acrylic Lens for glare reduction**
- **0-10v Dimming to 1% standard**
- **B.A.A. Compliant & Made in the USA by a Family Owned US Corporation**



DISCLAIMER: Although KURTZON has prepared the information contained in this document with all due care, KURTZON does not warrant or represent that the information is free from errors or omission. While the information is considered to be true and correct at the date of publication, changes in circumstances after the time of publication may impact on the accuracy of the information. The information may change without notice and KURTZON is not in any way liable for the accuracy of any information printed and stored or in any way interpreted or used.

## ORDERING GUIDE

Series	Material	Size	LED Type	CCT/CRI	Voltage	Options				
	1									
Series	Material	Size	Light Source		Voltage	Options				
			LED Type	CCT/CRI						
ML-F/PR Flange Install	1 White CRS Hsg.	6x48 6" x 48" Housing	2/LEDR	80 CRI:	120V	FC Fuse & Holder (One Supplied Per Circuit)				
		6x24 6" x 24" Housing	3/LEDR	830 3000K	277V	EM10 10W Integral LED EM				
ML-G/PR Grid Install	1 White CRS Hsg.	6x24 6" x 24" Housing	3/LEDR	835 3500K	UNV	RFI Providing with RF Filter for each circuit				
				840 4000K			347V*	LVC Low Voltage Controller		
				850 5000K					10KV 10KV Parallel Surge Protection (One Supplied Per Circuit)	
				90+ CRI:						AMW Anti-Microbial White Powdercoat
				935 3500K						
940 4000K										
Note: Two circuits, ambient and exam, are provided as standard.										

Ordering Notes, If Applicable

# Medical Patient Room Troffers: ML-GFPR-LED

6"x24" & 6"x48" LED Recessed Luminaire

## SPECIFICATIONS

**HOUSING:** Formed and Welded 20Ga Steel housing. Flange housing is provided with factory installed flange kit.

**REFLECTOR:** Full reflector panel designed to enhance asymmetric distribution. High reflectance white powder coat finished (minimum reflectivity 92%).

**LENS:** One piece frosted linear regressed acrylic lens conceals lamp image.

**LEDS:** Commercially available in a wide variety of Color Temperature (CCT), FLUX, and CRI. Highly efficient and consistent color maintained to 3 SDMC for color critical applications. B50/L70 and compliant with Zhaga recognized hole patterns. Consult factory for LED options or configurations not listed below.

**DRIVERS:** Standard Universal Voltage Class 2 drivers are 0-10v Dimmable to 1%. They come with at least 2.5Kv surge protection, have less than 10% THD at max load, Ballast Factor Greater than .95 and are programmable to match specific lumen or wattage requirements. Drivers with higher input voltage ratings are available, consult factory for driver specifications.

**INSTALL GRID:** Suitable for recessed Non-IC installation into covered ceilings. Adjustable Zee-brackets provide even support. See options for integrated seismic support brackets. Wireway access is through a removable plate containing two silicone sealed knockouts. Note: This fixture is not for plaster or drywall ceilings.

**INSTALL FLANGE:** Suitable for recessed Non-IC installation into covered ceilings. Two adjustable yoke mounting brackets provide even support. Wireway access is through a removable plate containing two silicone sealed knockouts. Note: This fixture is not for T-Bar Grid ceilings.

**FINISH:** White polyester powder coated over multi-stage pretreatment. See options for DuPont Alesta™ using Agion® silver ion antimicrobial powder coat finished housings.

**LISTINGS:** ETL listed per UL\_1598 for damp locations. Drivers and LEDs are covered by a 5 year warranty, the remaining fixture is covered by a 10 year warranty. This product is Buy American Act (B.A.A.) compliant.

## PRODUCT DRAWINGS

6x48 PATIENT ROOM				
SIZE	DIM A	DIM B	DIM C	DIM D
6 x 48	47.68"	4.30"	46.06"	5.68"
6 x 24	23.68"	4.30"	22.50"	5.68"

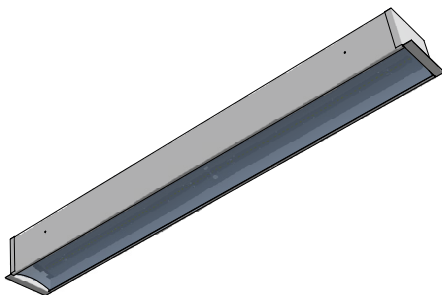
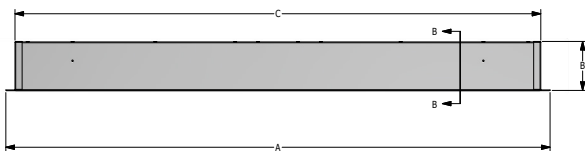
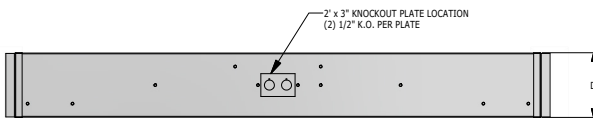

14-AA-L-6x48 PATIENT ROOM DWG DATE: 12/20/2018

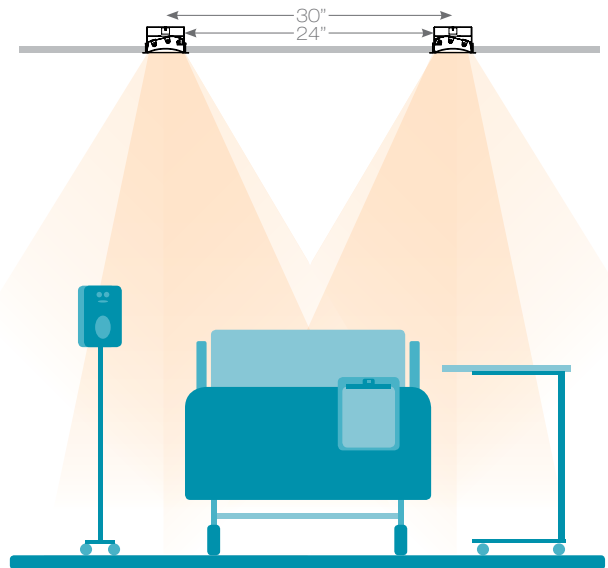

Two recessed asymmetric distribution luminaires installed at 30 inches on center provide examination level illumination across the full bed surface.

# Medical Patient Room Troffers: ML-GFPR-LED

6"x24" & 6"x48" LED Recessed Luminaire

## ENERGY DATA

LED PATIENT ROOM TROFFER WITH EXAM/AMBIENT MODE									
ENCLOSURE SIZE	LIGHT PACKAGE	80 CRI			90 CRI			DIMMING AVAILABILITY	MAX AMBIENT TEMP <sup>4</sup> (°C)
		LUMENS <sup>1</sup>	WATTAGE <sup>2</sup>	EFFICACY <sup>3</sup>	LUMENS <sup>1</sup>	WATTAGE <sup>2</sup>	EFFICACY <sup>3</sup>		
6x48	1 LED AMBIENT	2,013	29	70	1,930	29	67	0-10V 1%	40°C (104°F)
6x48	1 LED EXAM + 1 LED AMBIENT	5,295	56	95	5,077	56	91	0-10V 1%	40°C (104°F)
6x48	2 LED EXAM + 1 LED AMBIENT	8,491	85	100	8,142	85	96	0-10V 1%	40°C (104°F)
6x24	1 LED AMBIENT	990	15	66	945	15	63	0-10V 1%	40°C (104°F)
6x24	1 LED EXAM + 1 LED AMBIENT	2,595	30	87	2,485	30	83	0-10V 1%	40°C (104°F)
6x24	2 LED EXAM + 1 LED AMBIENT	4,160	44	95	3,990	44	91	0-10V 1%	40°C (104°F)
ALL	EM10 <sup>5</sup>	870-950	4	NA	830-960	4	NA	NA	40°C (104°F)

- <sup>1</sup> DELIVERED LUMEN DATA IS EXTRAPOLATED FROM MEASURED DATA @25C WITH NO EXTRA OPTIONS. VARIANCES WILL OCCUR WHEN OTHER SELECTIONS ARE MADE
- <sup>2</sup> WATTAGE IS MEASURED WITH LED 840 SELECTION @ 120vac AND Tambient = 25C. WATTAGES WILL VARY AND INCREASE WHEN ALTERNATE OPTOINS ARE SELECTED
- <sup>3</sup> EFFICACY CALCULATED USING 80 CRI 4000K CCT DATA.
- <sup>4</sup> MAX TEMP RATING IS WITH NO OTHER OPTIONS SELECTED.
- <sup>5</sup> INITIAL LUMEN VALUE IN EMERGENCY MODE CALCULATED WITH LEAST EFFICIENT CONFIGURATION BY (10W)\*(NORMAL LUMENS / NORMAL WATTS) AVAILABLE 48" ONLY

## PHOTOMETRICS

### AMBIENT

Key:

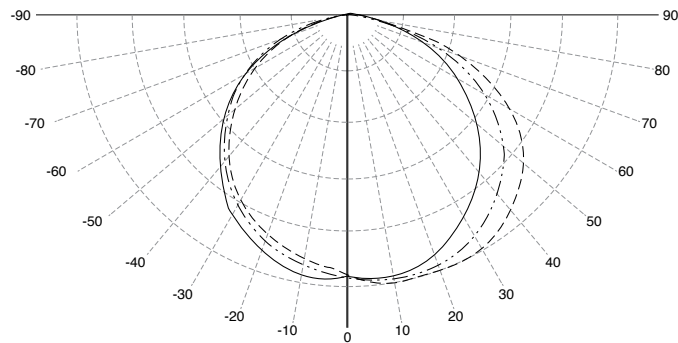
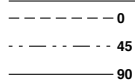

### EXAM

Key:

