

Medical Patient Room Troffers: ML-GFPR-LED-TW

Tunable White 6"x24" & 6"x48" LED Recessed Luminaire

- **For Patient Rooms**
- **2-Way Switching for Exam/Ambient Modes**
- **Frosted Acrylic Lens for glare reduction**
- **0-10v Dimming to 1% standard**
- **B.A.A. & B.A.B.A Compliant & Made in the USA by a Family Owned US Corporation**
- **Available as Warm Dim or as Separately controlled intensity and CCT**
- **Tunable white LEDs allow a full range of CCTS from 2700K - 6500K CCT**



DISCLAIMER: Although KURTZON has prepared the information contained in this document with all due care, KURTZON does not warrant or represent that the information is free from errors or omission. While the information is considered to be true and correct at the date of publication, changes in circumstances after the time of publication may impact on the accuracy of the information. The information may change without notice and KURTZON is not in any way liable for the accuracy of any information printed and stored or in any way interpreted or used.

ORDERING GUIDE

Series	Material	Size	Row Qty.	LED Type	CCT/CRI	Control	Voltage	Options
	1			LEDTW				

Series	Material	Size	Light Source			Control	Voltage	Options
			Row Qty.	LED Type	CCT/CRI			
ML-F/PR Flange Install	1 White CRS Hsg.	6x48 6" x 48" Housing	2	LEDTW	80 CRI:	10VA 0-10V Analog Control	120V	FC Fuse & Holder (One Supplied Per Circuit)
		6x24 6" x 24" Housing	3		827/865 2700K-6500K		277V	EM10 10W Integral LED EM
					90+ CRI:		UNV	RFI Providing with RF Filter for each circuit
					927/965 2700K-6500K			10KV 10KV Parallel Surge Protection (One Supplied Per Circuit)(Grid)
ML-G/PR Grid Install						10VWD 0-10V Warm Dim Control	AMW Anti-Microbial White Powdercoat	
Note: Two circuits, ambient and exam, are provided as standard.								

Ordering Notes, If Applicable

Medical Patient Room Troffers: ML-GFPR-LED-TW

Tunable White 6"x24" & 6"x48" LED Recessed Luminaire

SPECIFICATIONS

HOUSING: Formed and Welded 20Ga Steel housing. Flange housing is provided with factory installed flange kit.

REFLECTOR: Full reflector panel designed to enhance asymmetric distribution. High reflectance white powder coat finished (minimum reflectivity 92%).

LENS: One piece frosted linear regressed acrylic lens conceals lamp image.

LEDs: Commercially available minimum 80 or 90 CRI 2 channel LED modules use 2700K and 6500K chips to mix color in order to achieve a desired color temperature. Modules have rated lifetime of L70 > 50,000 hrs and efficacy of 165Lm/W . LEDs are controllable via 0-10v dimming, see next page for control options. Consult factory for lumen output configurations not listed on spec sheets.

DRIVERS: Standard Universal Voltage Class 2 drivers are 0-10v Dimmable to 1%. They come with at least 2.5Kv surge protection, have less than 10% THD at max load, Ballast Factor Greater than .95 and are programmable to match specific lumen or wattage requirements. Drivers with higher input voltage ratings are available, consult factory for driver specifications.

INSTALL GRID: Suitable for recessed Non-IC installation into covered ceilings. Adjustable Zee-brackets provide even support. See options for integrated seismic support brackets. Wireway access is through a removable plate containing two silicone sealed knockouts. Note: This fixture is not for plaster or drywall ceilings.

INSTALL FLANGE: Suitable for recessed Non-IC installation into covered ceilings. Two adjustable yoke mounting brackets provide even support. Wireway access is through a removable plate containing two silicone sealed knockouts. Note: This fixture is not for T-Bar Grid ceilings.

FINISH: White polyester powder coated over multi-stage pretreatment. See options for DuPont Alesta™ using Agion® silver ion antimicrobial powder coat finished housings.

LISTINGS: ETL listed per UL_1598 for damp locations. Drivers and LEDs are covered by a 5 year warranty, the remaining fixture is covered by a 10 year warranty. This product Series is both Build America Buy America (B.A.B.A.) & Buy American Act (B.A.A.) compliant.

PRODUCT DRAWINGS

6x48 PATIENT ROOM				
SIZE	DIM A	DIM B	DIM C	DIM D
6 x 48	47.68"	4.30"	46.06"	5.68"
6 x 24	23.68"	4.30"	22.50"	5.68"

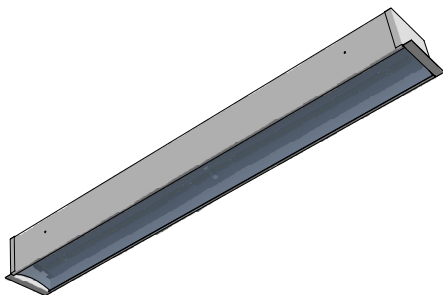
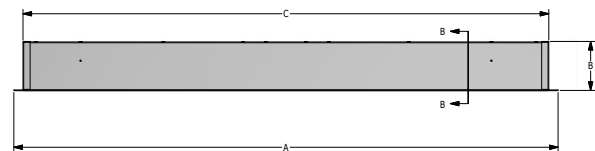
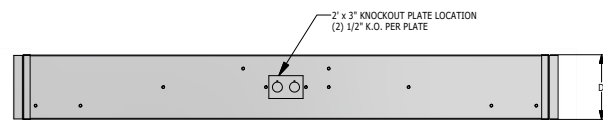

14-AA-L-6x48 PATIENT ROOM DWG DATE: 12/20/2018

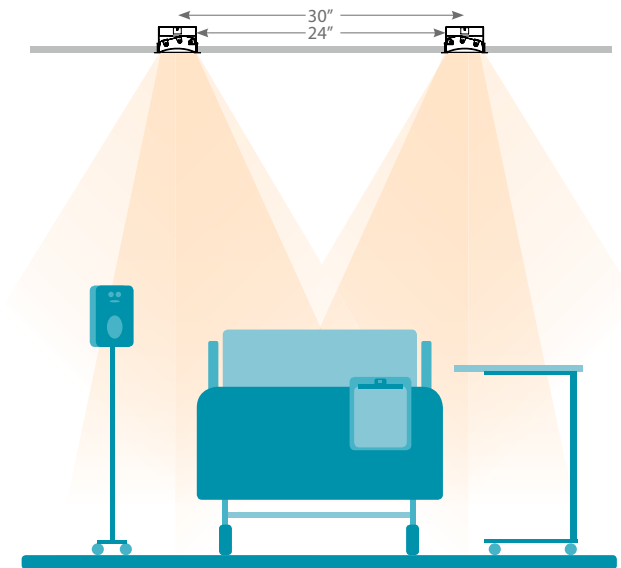

Two recessed asymmetric distribution luminaires installed at 30 inches on center provide examination level illumination across the full bed surface.

Medical Patient Room Troffers: ML-GFPR-LED-TW

Tunable White 6"x24" & 6"x48" LED Recessed Luminaire

ENERGY DATA

LED PATIENT ROOM TROFFER WITH EXAM/AMBIENT MODE						
ENCLOSURE SIZE	LIGHT PACKAGE	Tunable White 80 CRI (4000K)			CCT RANGE	MAX AMBIENT TEMP ⁴ (°C)
		LUMENS ¹	WATTAGE ²	EFFICACY ³		
6x48	1 LED AMBIENT	1,900	29	66	2700k - 6500k	40°C (104°F)
6x48	1 LED EXAM + 1 LED AMBIENT	5,000	59	85	2700k - 6500k	40°C (104°F)
6x48	2 LED EXAM + 1 LED AMBIENT	8,150	84	97	2700k - 6500k	40°C (104°F)
6x24	1 LED AMBIENT	950	15	63	2700k - 6500k	40°C (104°F)
6x24	1 LED EXAM + 1 LED AMBIENT	2,450	30	82	2700k - 6500k	40°C (104°F)
6x24	2 LED EXAM + 1 LED AMBIENT	4,050	44	92	2700k - 6500k	40°C (104°F)
ALL	EM10 ⁵	900*	4	NA	NA	40°C (104°F)

- 1 DELIVERED LUMEN DATA IS CALCULATED BASED ON STATIC WHITE PHOTOMETRY @ 4000K CCT
- 2 WATTAGE IS MEASURED @ 120vAC AND Tambient = 25C. WATTAGES MAY VARY WITH ALTERNATE CONFIGURATIONS
- 3 EFFICACY CALCULATED USING 80 CRI 4000K CCT DATA.
- 4 MAX TEMP RATING IS WITH NO OTHER OPTIONS SELECTED.
- 5 90 MINUTE 10W EMERGENCY DRIVER; LUMENS CALCULATED BASED ON FIXTURE EFFICACY.

PHOTOMETRICS

AMBIENT

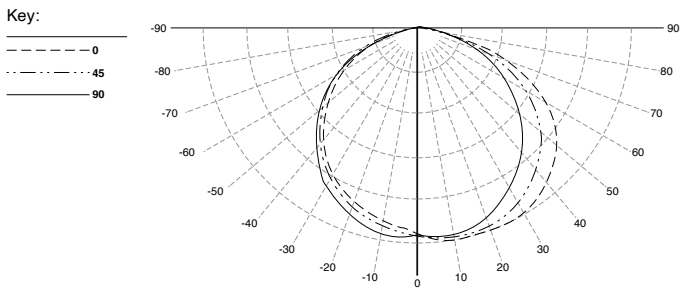

EXAM

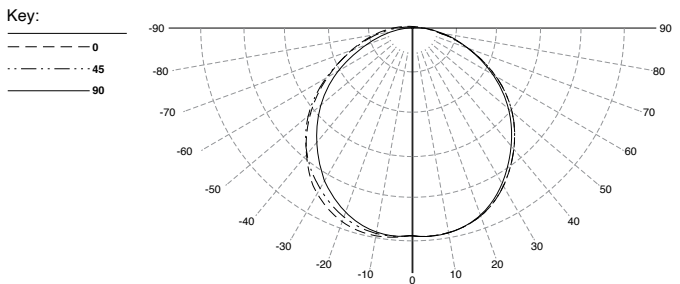

CONTROL OPTIONS

WARM DIM CONTROL

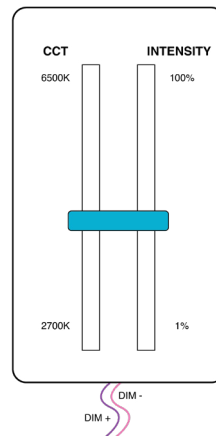

Only one set of dimming Leads are required. As Intensity is Increased so is the CCT. As intensity decreases the CCT decreases to warmer color Temperatures.

CONTINUOUS CCT CONTROL

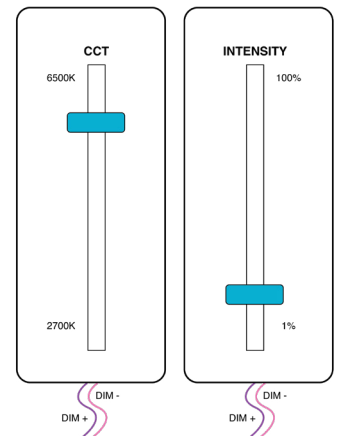

Two set of dimming leads are required. Intensity and CCT of light are controlled independently from one another.