

Food Processing Narrow Light Bar: FP-NLB

2ft, 4ft, 8ft Surface or Suspended Linear Light Bar

- Durable aluminum housing with polyacrylate lens
- Black, White, and Aluminum finishes
- Narrow, Medium, and Wide lighting distributions
- Several mounting options to fit any application
- Serial Connection option to daisy-chain multiple light bars
- 0-10V Dimmable standard
- IP69K and IK09 Rated
- NSF Certified Option for Food Processing Applications
- Field tested to 3000 PSI



DISCLAIMER: Although KURTZON has prepared the information contained in this document with all due care, KURTZON does not warrant or represent that the information is free from errors or omission. Whilst the information is considered to be true and correct at the date of publication, changes in circumstances after the time of publication may impact on the accuracy of the information. The information may change without notice and KURTZON is not in any way liable for the accuracy of any information printed and stored or in any way interpreted or used.

ORDERING GUIDE

Series	Size	CCT/CRI	Voltage	Optics	Finish	Mounting Brackets	Options
FP-NLB			UNV				
Series	Size	CCT/CRI	Voltage	Optics	Finish	Mounting Brackets	Options
FP-NLB	20-LEDR Nom. 2FT Length	80 CRI:	UNV 120-277 VAC	CPNB Clear Polycarb. 30° Beam Angle	WHT White Powdercoat	SCM Surface Channel Mount	3WC06 6FT 3Wire Cord
	40-LEDR Nom. 4FT Length	830 3000K		CPMB Clear Polycarb. 60° Beam Angle	BLK Black Powdercoat	AMB Adjustable Mount	5WC06 6FT 5Wire Cord (Standard)
	40-LEDH Nom. 4FT Length	840 4000K		CPWB Clear Polycarb. 120° Beam Angle	ALM Raw Aluminum	SSM Surface Smooth Mount	3WCXX XXFT 3Wire Cord (Replace XX w/ Length in FT)
	60-LEDH Nom. 6FT Length	850 5000K		FPWB Frost Polycarb. 120° Beam Angle			5WCXX XXFT 5Wire Cord (Replace XX w/ Length in FT)
	80-LEDH Nom. 8FT Length						DCM Daisy Chain Mount (via paired cordsets)*
						*Length and quantity must be specified at time of the order	
						Optional Accessories Ordered Separately	
						2XB 2 Light Bar Bracket (Side By Side)	
						3XB 3 Light Bar Bracket (Side By Side)	
						5XB 5 Light Bar Bracket (Side By Side)	
						Brackets provided loose - quantity must be specified at time of the order	
						Not NSF Certified	
						*Must specify luminaire quantity in each row	

Ordering Notes, If Applicable

Food Processing Narrow Light Bar: FP-NLB

2ft, 4ft, 8ft Surface or Suspended Linear Light Bar

SPECIFICATIONS

CONSTRUCTION: The body of the Narrow Light Bar is made of just a few extruded aluminum and polycarbonate pieces, making it both a rugged and resilient luminaire as well as one with an architectural aesthetic. The NSF-rated version of the Narrow Light Bar has no channels or areas where water can collect, thereby eliminating the potential for algae or mold growth.

OPTICS: An offering of 30°, 60°, or 120° beam angles are available for all Narrow Light Bars to cover all potential application needs. The 30° and 60° options are produced with a clear lens while the 120° option can be clear or frosted.

ELECTRICAL: The Narrow Light Bar comes standard with a high-performance driver that goes from 100-277V, Power Factor >.9 with THD <.2, internal to the fixture. A minimum CRI of 80 is provided in 3000K, 4000K, and 5000K color temperatures. 4kV surge protection and 0-10V dimmable standard. Bars have a 6' power cord with longer lengths available on request.

INSTALLATION: Available options include pendant and flush mounting options for individual units. For combined units bracketed together there are additional options for both how they bracket together, as well as mount to fixed structures or pendant. All necessary hardware is included with the brackets.

CERTIFICATIONS & LISTINGS: ETL certified to UL1598. Suitable for Wet Locations and Natatoriums. Certified to NSF/ANSI 2 for Splash and Non-food Zones. IP69K and IK09 Rated.

DAISY CHAIN MOUNTING (DCM) DETAIL

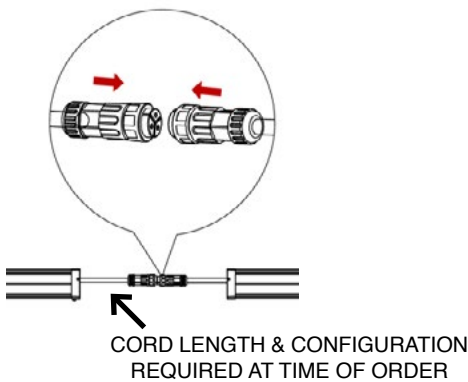

PRODUCT DIMENSIONS

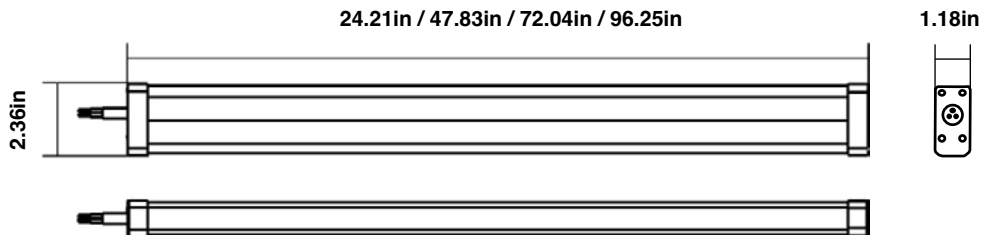

MOUNTING OPTIONS

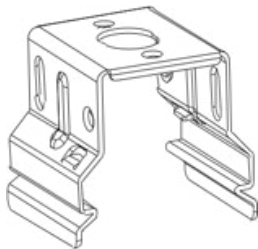

SCM
Surface Channel Mount



AMB
Adjustable Mount

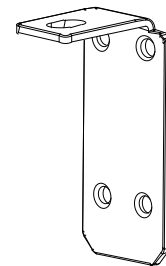

SSM
Surface Smooth Mount (NSF Listed Option)

Food Processing Narrow Light Bar: FP-NLB

2ft, 4ft, 8ft Surface or Suspended Linear Light Bar

ENERGY DATA

WEIGHT

LED SPECIFICATION			3000K		4000K		5000K		WATTS	AMBIENT OPERATING TEMP	
MODEL	OUTPUT	OPTICS	LUMENS	EFFICACY	LUMENS	EFFICACY	LUMENS	EFFICACY		MIN	MAX
FP-NLB-20 FP-NLB-40	LEDR	CPNB	3,160	109 lm/W	3,227	111 lm/W	3,362	116 lm/W	29	-25°C (-13°F)	65°C
		CPMB	3,084	106 lm/W	3,150	109 lm/W	3,281	113 lm/W	29		
		CPWB	4,384	157 lm/W	4,477	160 lm/W	4,664	167 lm/W	28		
		CPWB	3,973	142 lm/W	4,058	145 lm/W	4,227	151 lm/W	28		
FP-NLB-40 FP-NLB-60 FP-NLB-80	LEDH	CPNB	6,123	104 lm/W	6,253	106 lm/W	6,514	110 lm/W	59		
		CPMB	5,852	99 lm/W	5,976	101 lm/W	6,225	106 lm/W	59		
		CPWB	8,650	152 lm/W	8,834	155 lm/W	9,202	161 lm/W	57		
		FPWB	7,670	135 lm/W	7,833	137 lm/W	8,160	143 lm/W	57		

FP-NLB WEIGHT
20: 2.25lbs
40: 3.75lbs
60: 5.25lbs
80: 6.75lbs

PHOTOMETRICS

1/LEDR

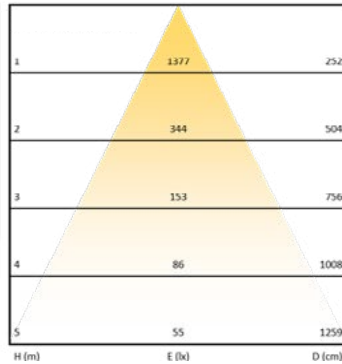
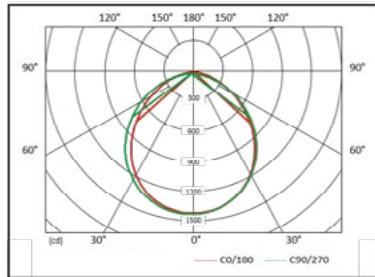

1/LEDH

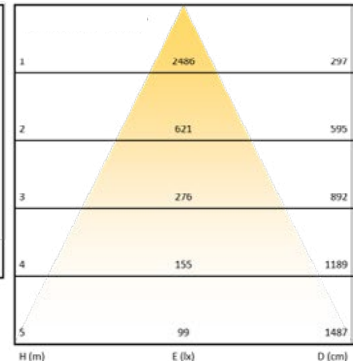
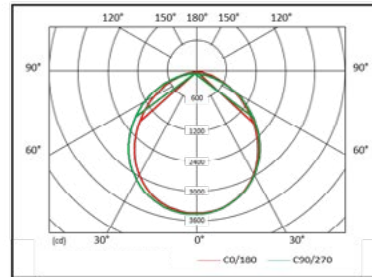

OPTIONAL ACCESSORIES

M2 - MULTIPLE UNITS, (2) Light Bars
Springloaded Adjustable Bracket for Double Bar Fixture.

M3 - MULTIPLE UNITS, (3) Light Bars
Springloaded Adjustable Bracket for Triple Bar Fixture.

M5 - MULTIPLE UNITS, (5) Light Bars
Springloaded Adjustable Bracket for Quintuple Bar Fixture.

