

Food Processing Top Access High Bay: FP-IMP-2X2LP-4/2LED

2x2 Recessed LED Luminaire With Top Access for IMP Ceilings with Plenum Uplight and Downlight

- **625 lb Direct Static Load Rating**
- **For Recessed Installation Into 4" Insulated Metal Panel (IMP) Ceilings (5" and 6" Optional)**
- **Accessible From Plenum Side Of Ceiling Only**
- **Ambient Operating Temp up to 55°C (131°F)**
- **Evaluated and approved by ETL for installation into IMP ceilings.**
- **Luminaire may be in direct contact with IMP ceiling's insulation, eliminating need to cap off the rough-in saving time and money.**
- **Uplight provides illumination on service side of ceiling**
- **Downlight provides illumination in processing side of ceiling**
- **B.A.A. & B.A.B.A Compliant & Made in the USA by a Family Owned US Corporation**

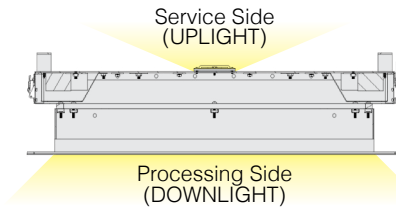

DISCLAIMER: Although KURTZON has prepared the information contained in this document with all due care, KURTZON does not warrant or represent that the information is free from errors or omission. Whilst the information is considered to be true and correct at the date of publication, changes in circumstances after the time of publication may impact on the accuracy of the information. The information may change without notice and KURTZON is not in any way liable for the accuracy of any information printed and stored or in any way interpreted or used.



ORDERING GUIDE

Series	Material	Size	Light Source	CCT/CRI	Voltage	Downlight Optics	Uplight Optics	Options
FP-IMP		2x2 LP	4LEDFE/2LEDUP					

Series	Material	Size	Light Source	CCT/CRI	Voltage	Room Side Optics	Plenum Side Optics (For Up Light Only)	Options			
FP-IMP	1	2x2 LP 2x2 Housing	4LEDFE/2LEDUP 6 High Powered LEDs (4 Down/2 Up)	80 CRI:	120V	P12ACR	0.135" P12 Prismatic Impact Resistant Acrylic (Inverted)	CP30	30° Narrow Beam Optic	FC	Fuse & Holder (One Supplied Per Circuit)
				830	3000K	277V	LEX	0.125" P12 Prismatic Polycarbonate (Inverted)	CP60	60° Medium Beam Optic	EM20
	840			4000K	UNV	A19	0.156" A19 Prismatic Impact Resistant Acrylic (Inverted)	CP90	90° Wide Beam Optic	WHT	White Finished Door & HSG
	850			5000K	347V*	TG	0.156" Prismatic Tempered Glass (Inverted)	CPV130	130° Type V Optic	PxL	Programmed to User Specified Lumen Value. 0-∞
	2	White CRS Hsg. & Polished SS Door		480V*	HIA	0.140" P12 Prismatic High Impact Resistant Acrylic (Inverted)	NOTE: CP90 optic is standard and will be provided when no other option is selected	PxW	Programmed to User Specified Wattage Value. 0-∞		
				FROST	0.125" Flat Diffusing Frost Acrylic	10KV		10KV Parallel Surge Protection (One Supplied Per Circuit)			
				2DBW	0.125" Flat Diffused Acrylic with Bi-Directional Batwing Distribution	GTD		Generator Transfer Device			
				LBW	0.125" Flat Diffused Acrylic with Linear Batwing Distribution	IMP5		Fixture Suitable for 5" IMP			
				GH85	0.125" Flat Diffused Acrylic with Glare Suppression Distribution	IMP6		Fixture Suitable for 6" IMP			
				NOTE: FROST option is standard and will be provided when no other option is selected		1/CPB		Locking Cordset with Plug and Junction box termination			
				CORD	Must specify Length/type/Wire Qty						
	WHIP	Must Specify Length and Wire Qty									
	AMW	Anti-Microbial White Powdercoat									
FZNC	NSF Food Zone Non-Contact Rating (adds a FDA approved room side lens)										
OCCUP	Plenum Side Occupancy Sensor										

Ordering Notes, If Applicable

Food Processing Top Access High Bay: FP-IMP-2X2LP-4/2LED

2x2 Recessed LED Luminaire With Top Access for IMP Ceilings with Plenum Uplight and Downlight

SPECIFICATIONS

HOUSING: Welded, sealed, and hole-free CRS Housing with latches secured for accessing the electrical panel.

DOOR FRAME: Overlapping style trim flange made from 14Ga powdercoated cold rolled steel or 14Ga polished 304 stainless steel. The trim frame is secured to the housing by 12 #12-24 screws that are only accessible from the plenum side of the ceiling. All hardware is concealed for cleanability.

GASKETS: NSF Listed closed cell microcellular extruded gasket with vulcanized corners, making a one-piece oil and solvent-resistant gasket system.

DOWNWARD OPTICS: Downward optics diffuse light, illuminating the processing space below the IMP ceiling. Standard frost acrylic lens is provided when no other options are selected. All prismatic lensing options come with an inverted lens, so the smooth side faces the room for easy cleaning. All optics are sealed to the door with NSF-listed RTV silicone sealant. It is also available with 3 different light guide film overlays designed for diffusing or distributing light. Consult the factory for more information or options not shown.

UPLIGHT OPTICS: Uplight optics diffuse light illuminating the plenum space above the IMP ceiling. Sealed IP Rated Optics secure over the LED installed on the outside of the IMP fixture to protect and diffuse the LED module. Available in 4 distributions including a narrow 30° beam, medium 60° beam, wide 90° beam, or type V 130° beam. Uplight optics have a dedicated switched circuit but can also optionally be controlled with a dimmable plenum side occupancy sensor for easier installation.

TOP COVER 2X2LP: Houses all electrical components and is easily removable from the plenum side by the use of (4) rotary draw latches. The 2x2LP version is available with four downward-facing linear modules and two upward rectangular modules that are available in 80CRI only. High-efficiency modules do not require heat sinking, allowing the top cover to be smaller and lighter. Provided with UL listed class 2 programmable power supplies that can dim down to 5% via 0-10V dimming. Power supplies have 6KV of surge protection built into them. Fixture comes standard as 2 circuit switching for up and downlight.

INSTALLATION: Two .875" supply entrances for conduit connection. Designed to clamp a 4" IMP ceiling, optionally available for 5" and 6" ceilings. Rated for 625lb static load (not intended to be walked on). Available with specified locking cordsets for quicker servicing and installation. Consult the factory for cord options.

FINISH: Stainless steel door frames are satin polished unless WHT or AMW options are selected. All other materials are provided with gloss high reflectance white polyester powdercoat with 1000hr salt spray test per ASTM B117. AMW option provides a white anti-microbial polyester powder coat on the frame.

LISTINGS: NSF2-Listed for Non-Food & Splash Zones, optionally listed for Food Zone Non-Contact with FZNC option. Suitable for 1700 PSI high-pressure hosedowns. ETL-Listed per UL_1598 for wet locations. Chicago Plenum Rated. Drivers and LEDs are covered by a 5-year warranty, the remaining fixture is covered by a 10-year warranty. Suitable for direct static loads up to 625 lbs, not intended to be walked on. This product Series is both Build America Buy America (B.A.B.A.) & Buy American Act (B.A.A.) compliant.

ENERGY DATA

IMP-2X2LP-2LEDUP (UPWARD LIGHT) 80 CRI												
ENCLOSURE SIZE	LIGHT PACKAGE	CP30 / CP90			CP60			CPV130			DIMMING	MAX AMBIENT
		Lumens	Wattage	Efficacy	Lumens	Wattage	Efficacy	Lumens	Wattage	Efficacy	AVAILABILITY	TEMP (°C)*
2X2LP	2LEDUP (UP)	9074	61	149	8,978	61	147	9367	61	154	0-10V 5%	55°C (131°F)

IMP-2X2LP-4LED (DOWNWARD LIGHT) 80 CRI												
ENCLOSURE SIZE	LIGHT PACKAGE	CLEAR LENS			FROST LENS			DELIVERED LUMEN SCALARS²			DIMMING	MAX AMBIENT
		Lumens	Wattage	Efficacy	Lumens	Wattage	Efficacy	P12ACR	2DBW	GH85	AVAILABILITY	TEMP (°C)*
2X2LP	4LED (DWN)	26880	210	128	25,700	210	122	1.02	0.99	0.98	0-10V 5%	55°C (131°F)
2X2LP	EM20³	N/A	20	N/A	2440	20	N/A	N/A	20	N/A	0-10V 5%	50°C (122°F)

¹ ENERGY DATA IS EXTRAPOLATED FROM MEASURED DATA @ 25°C WITH NO EXTRA OPTIONS. VARIANCES WILL OCCUR WHEN OTHER SELECTIONS ARE MADE

² LUMEN SCALER ARE DELIVERED LUMEN MULTIPLIERS FROM FROST LENS LUMEN

³ INITIAL LUMEN VALUE CALCULATED BY (20W)*(NORMAL LUMENS/NORMAL WATTAGE).

⁴ MAX TEMP LIMIT DECREASES BY 10C WHEN BOTH UP AND DOWN ARE ILLUMINATED FOR PROLONGED PERIODS OF TIME.

Food Processing Top Access High Bay: FP-IMP-2X2LP-4/2LED

2x2 Recessed LED Luminaire With Top Access for IMP Ceilings with Plenum Uplight and Downlight

PHOTOMETRICS - DOWNLIGHT OPTICS (PROCESSING SIDE)

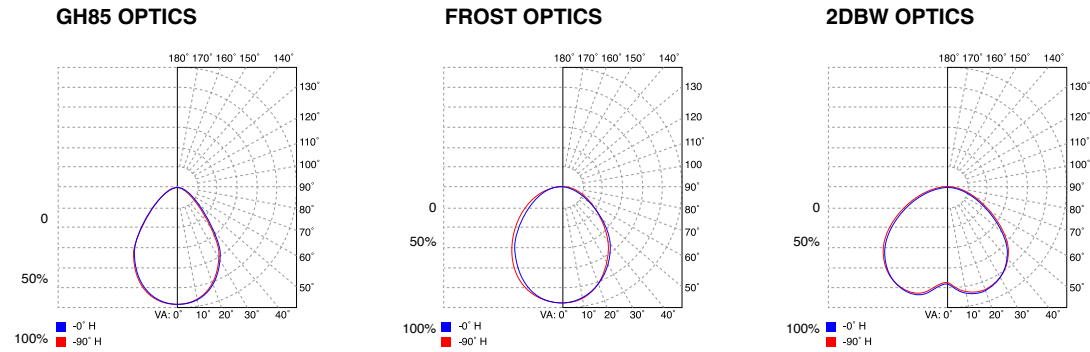

PHOTOMETRICS - UPLIGHT OPTICS (SERVICE SIDE)

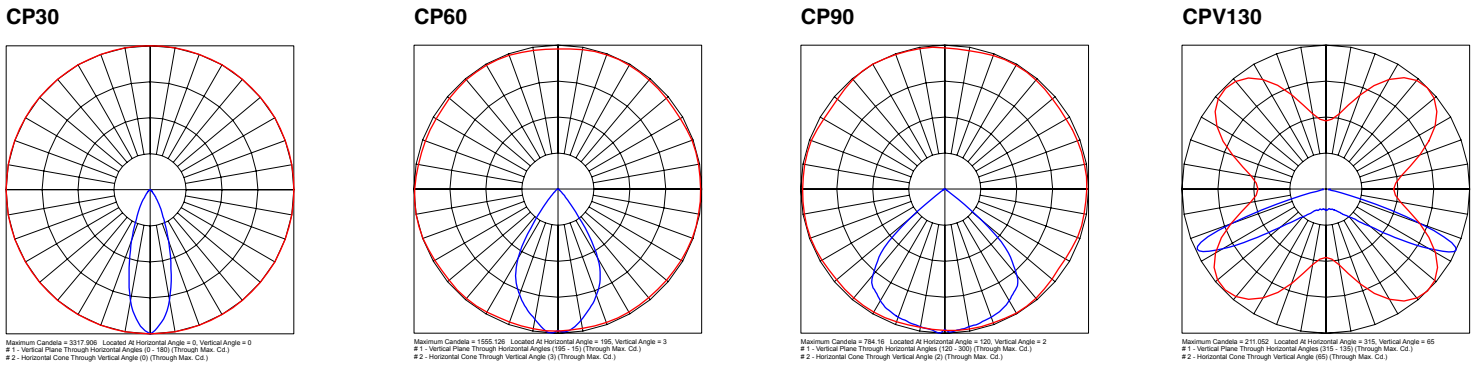

Food Processing Top Access High Bay: FP-IMP-2X2LP-4/2LED

2x2 Recessed LED Luminaire With Top Access for IMP Ceilings with Plenum Uplight and Downlight

PRODUCT DRAWINGS

OVERLAPPING IMP 2X2LP GEN2 REFERENCE DIMENSIONS								
SIZE	A	B	C	D	E	F	G	H
2X2	22.57"	22.66"	26.63"	26.63"	25.69"	4.00"	2.35"	4.00"

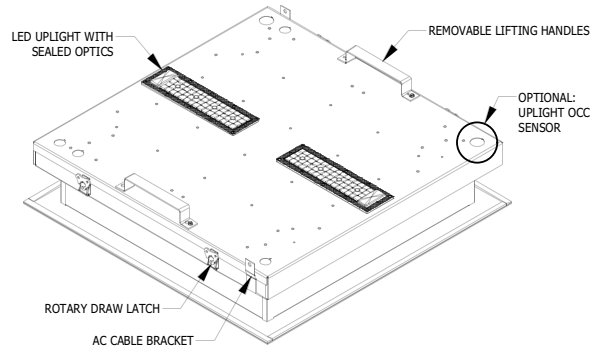
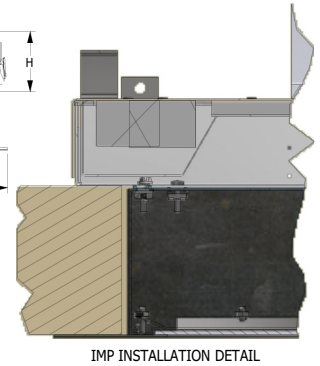
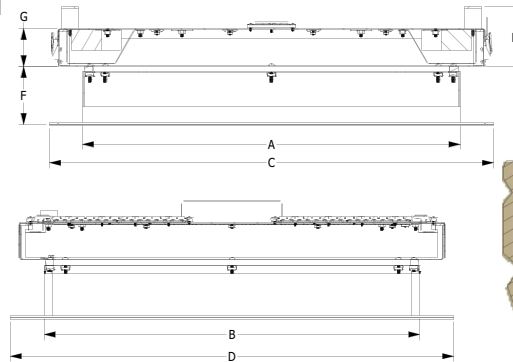
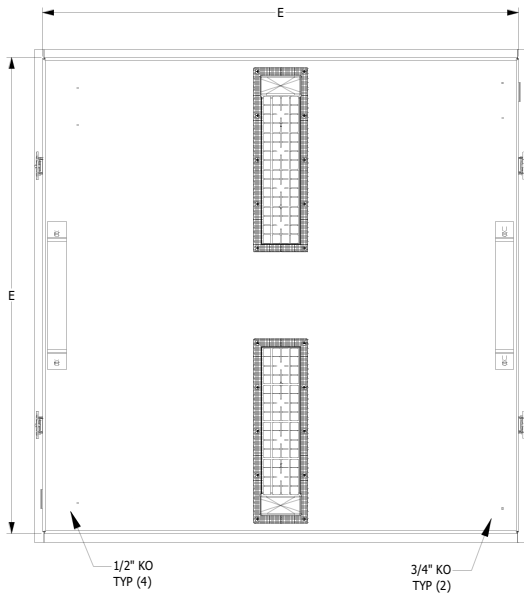

-CEILING CUTOUT-
23" X 23" .125"

10-AB-L-FP IMP UP DWG DATE: 11/13/2023