

Food Processing Profile Wrap: FP-B-LED

Sealed Surface High Efficiency LED Wrap Luminaire

- **ETL Listed for Wet Locations**
- **IP65 Rating**
- **Several Mounting options for surface or suspended installation**
- **Suitable for use in NSF Non-Food & Splash Zones**
- **Optionally available for end to end row mounting.**
- **B.A.A. & B.A.B.A Compliant & Made in the USA by a Family Owned US Corporation**



DISCLAIMER: Although KURTZON has prepared the information contained in this document with all due care, KURTZON does not warrant or represent that the information is free from errors or omission. While the information is considered to be true and correct at the date of publication, changes in circumstances after the time of publication may impact on the accuracy of the information. The information may change without notice and KURTZON is not in any way liable for the accuracy of any information printed and stored or in any way interpreted or used.

ORDERING GUIDE

Series	Optics	Material	Size	Row Qty.	LED Type	CCT/CRI	Voltage	Options
FP					LEDR			

Series	Optics	Material	Size	Light Source			Voltage	Options
				Row Qty.	LED Type	CCT/CRI		
FP	B Frosted Acrylic	1 White CRS Ext. Hsg. & White CRS Int.	20 2' Housing	2	LEDR	83 CRI:	120V	FC Fuse & Holder (One Supplied Per Circuit)
			40 4' Housing	3		830 3000K	277V	EDL -40F Electronic Driver
	LPB Clear Linear Prismatic Poly	3 Polished 304 SS ext. & 304 SS int.				835 3500K	UNV	EM10** 10W Integral LED EM (Specify Input Voltage)
						840 4000K	347V*	CRM Continuous Row Mounting
						850 5000K		TP Stainless Steel Tamperproof Fasteners
	FPB Frosted Linear Prismatic Poly	4 White Alum Ext. & White CRS Int.						SW Sealed Wireway for Conduit End Feed (each end)
						90+ CRI:		WHT White Finished Door & HSG
						935 3500K		PMB (2) Pendant Mount Brackets (Pendants or Chains by Others)
						940 4000K		CMB (2) Corner Mount Brackets
						950 5000K		AMB (2) Adjustable Mount Brackets
								PxL* Programmed to User Specified Lumen Value.
								PxW* Programmed to User Specified Wattage Value.
								10KV 10KV Parallel Surge Protection (One Supplied Per Circuit)
								GTD*** Generator Transfer Device
								WHIP Must Specify Length and Wire Qty
							OCCMW Integral microwave occ sensor (32' max)	
							OCCHB External PIR occ sensor (end mount 20'-40')	
							OCCLB External PIR occ sensor (end mount 8'-10')	
							AMW Anti-Microbial White Powdercoat	
								Note: EM10 remote mount for 2' housing *Note: specify value in ordering notes below *Note: GTD N/A for 2' housing

**Note: EM10 remote mount for 2' housing
*Note: specify value in ordering notes below
***Note: GTD N/A for 2' housing

Ordering Notes, If Applicable

Food Processing Profile Wrap: FP-B-LED

Sealed Surface High Efficiency LED Wrap Luminaire

SPECIFICATIONS

HOUSING: Double channel housing of 20Ga 1008 Cold Rolled Steel, 20Ga 304 Stainless Steel, or .040" 3003 Aluminum construction.

END CAPS: Precision stamped 20Ga 304 Stainless Steel end caps secured to housing with captive stainless steel Flush head screws. SW Option provides a 3 piece conduit hub/ring/plug assembly installed in the endcap.

GASKETS: Closed cell 100% NSF listed nitrile gasketing. Resists aging, grease and solvents.

OPTICS: All lensing is extruded from a nominal 1/8" plastic material. Available in frosted acrylic, Clear Polycarbonate with linear ribs, or Clear Polycarbonate with a frosted inlay.

LEDs: Commercially available in a wide variety of Color Temperature (CCT), FLUX, and CRI. Highly efficient and consistent color maintained to 3 SDMC for color critical applications. B50/L70 and compliant with Zhaga recognized hole patterns. Consult factory for LED options or configurations not listed below.

DRIVERS: Standard Universal Voltage Class 2 drivers are 0-10v Dimmable to 1% for most LED configurations. They come with at least 2.5Kv surge protection, have less than 10% THD at max load, Ballast Factor Greater than .95 and are programmable to match specific lumen or wattage requirements. Drivers with higher input voltage ratings are available, consult factory for driver specifications.

REFLECTOR: Die formed metal with high reflectance white polyester powder coat finish. Typical reflectivity 92%.

INSTALL SURFACE: Suitable for wet location installation under covered ceilings only. Luminaire is provided with four 5/16" debossed holes for mounting. Power is brought in through 1/2" flattened conduit K.O. located on the bottom of luminaire. Power can also be brought through the end of the luminaire with SW option selected. Suitable for thru wiring.

ROWS: Joiner bands provided for continuous row mounting (See Option: CRM). Please specify number of fixtures in each run.

FINISH: Stainless steel housings are satin polished unless WHT or AMW options are selected. All other materials are provided with gloss high reflectance white polyester powder coat with 1000hr salt spray test per ASTM B117. AMW option provides a white anti-microbial polyester powder coat to all exposed surfaces.

LISTINGS: IP65 rated for dust and water ingress. ETL listed per UL_1598 for wet locations. Drivers and LEDs are covered by a 5 year warranty, the remaining fixture is covered by a 10 year warranty. Suitable for use in NSF non-food zones & Splash Zones. This product Series is both Build America Buy America (B.A.B.A.) & Buy American Act (B.A.A.) compliant.

PRODUCT DRAWINGS

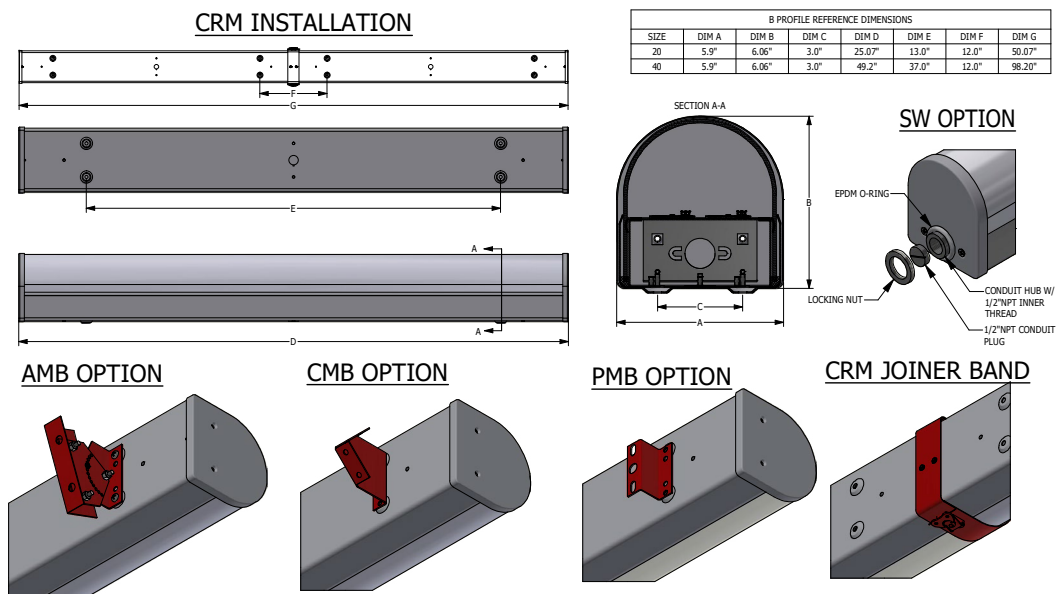

05-BA-L-B PROFILE WRAP DWG DATE: 10/12/22

Food Processing Profile Wrap: FP-B-LED

Sealed Surface High Efficiency LED Wrap Luminaire

ENERGY DATA

"B" PROFILE LED WRAP (APPROX ¹ LUMENS DELIVERED)											
LENS TYPE	ENCLOSURE SIZE	LED SELECTION	STANDARD DIMMING	83 CRI (5000K - 5000K)				90 CRI (5500K - 4000K)			
				LUMENS	WATTS ²	EFFICACY ³	MAX AMB TEMP ⁴	LUMENS	WATTS ²	EFFICACY ³	MAX AMB TEMP ⁴
B	20	2LEDR	0-10V 1%	3,539	29	122	40°C (104°F)	3,252	29	112	40°C (104°F)
FPB	20	2LEDR	0-10V 1%	2,960	29	102	40°C (104°F)	2,720	29	94	40°C (104°F)
LPB	20	2LEDR	0-10V 1%	3,578	29	123	40°C (104°F)	3,288	29	113	40°C (104°F)
B	20	3LEDR	0-10V 1%	5,300	44	120	40°C (104°F)	5,120	44	116	40°C (104°F)
FPB	20	3LEDR	0-10V 1%	4,400	44	100	40°C (104°F)	4,250	44	97	40°C (104°F)
LPB	20	3LEDR	0-10V 1%	5,400	44	123	40°C (104°F)	5,216	44	119	40°C (104°F)
B	40	2LEDR	0-10V 1%	7440	56	132	45°C (113°F)	6,837	56	122	45°C (113°F)
FPB	40	2LEDR	0-10V 1%	6,540	56	117	45°C (113°F)	6,010	56	107	45°C (113°F)
LPB	40	2LEDR	0-10V 1%	7,268	56	130	45°C (113°F)	6,679	56	119	45°C (113°F)
B	40	3LEDR	0-10V 1%	11,016	82	135	45°C (113°F)	10,154	82	125	45°C (113°F)
FPB	40	3LEDR	0-10V 1%	9,687	82	119	45°C (113°F)	8,902	82	109	45°C (113°F)
LPB	40	3LEDR	0-10V 1%	10,765	82	132	45°C (113°F)	10,155	82	124	45°C (113°F)

- ¹ DELIVERED LUMEN DATA IS EXTRAPOLATED FROM MEASURED DATA @25C WITH NO EXTRA OPTIONS. VARIANCES WILL OCCUR WHEN OTHER SELECTIONS ARE MADE
- ² WATTAGE IS MEASURED WITH 4000K SELECTION @ 120vAC AND Tambient = 25C. WATTAGES MAY VARY WITH ALTERNATE CONFIGURATIONS
- ³ EFFICACY CALCULATED USING 4000K CCT DATA.
- ⁴ MAX AMBIENT TEMP RATING. TEMP RATING MAY VARY WITH ALTERNATE SPECIFIED DRIVERS OR ANY NON STANDARD SELECTION
- ⁵ DELIVERED LUMENS FOR EM10 = (10W)*(EFFICACY) = DELIVERED LUMENS. EM10 ADDS 4W TO TOTAL LUMINAIRE

PHOTOMETRICS

B Optics

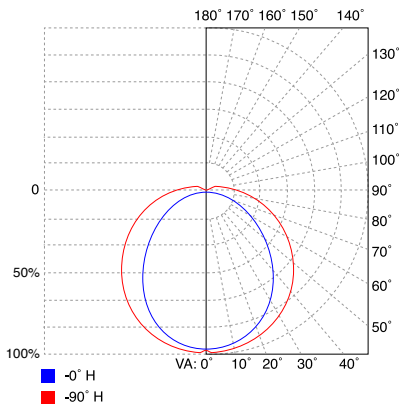

LPB Optics

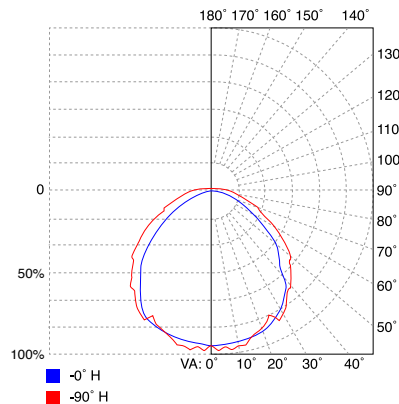

FPB Optics

