

Cleanroom KL Plenum Access Troffers

2x4 Fluorescent Luminaire with Plenum Access

- **IP66 Rating**
- **Suitable for ISO 3-9 Cleanspaces**
- **Suitable for 209E 1-100,000 Cleanspace**
- **UL Listed for Wet Locations**
- **Access to plenum space using sealed access panel in housing**
- **One piece overlapping door frame**
- **Robotically seam welded housing**
- **One Housing suitable for Flange and Grid Installations**
- **Made in the USA by a Family Owned US Corporation**



DISCLAIMER: Although KURTZON has prepared the information contained in this document with all due care, KURTZON does not warrant or represent that the information is free from errors or omission. Whilst the information is considered to be true and correct at the date of publication, changes in circumstances after the time of publication may impact on the accuracy of the information. The information may change without notice and KURTZON is not in any way liable for the accuracy of any information printed and stored or in any way interpreted or used.

ORDERING GUIDE

Series	Installation Type	Material	Size	Lamps	Voltage	Options
KL						
KL	FGPA: Recessed Luminaire for Grid and Flange with Plenum Access	1: White CRS Hsg. & White CRS Door 2: White CRS Hsg. & Polished 304 SS Door	2x4: 2' x 4' Housing	2,3,4 or 6/T5: F28T5 2,3,4 or 6/T5HO: F54FTHO	120V 277V UNV 347V*	FC: Fuse & Holder (One Supplied Per Circuit) 2/EB: Two Ballasts (Two Circuits) EBL: -20F Electronic Ballast WHT: White Finished Door & HSG LEX: .125" Prismatic Polycarbonate A19: .156" Prismatic P19 Pattern Clear Acrylic HIA: .140" High Impact P12 Pattern Clear Acrylic TG: .156" Prismatic Tempered Glass SW: Wet Location Hub Supplied (not installed) 1/EM: 1 Lamp EM (See Chart For Lamp Compatibility) 10KV: 10KV Parallel Surge Protection (One Supplied Per Circuit) GTD: Generator Transfer Device OCCMW: Internal microwave OCC Sensor WHIP: Must Specify Length and Wire Qty

Cleanroom KL Plenum Access Troffers

2x4 Fluorescent Luminaire with Plenum Access

SPECIFICATIONS

HOUSING: One piece, seam welded, hole free 20-gauge CRS construction. Plenum access panel secured over 16" x 40" plenum access opening with captive screws and keyhole slots. Fully white powder coated.

DOOR FRAME: One piece door frame with welded corners overlaps the fixture allowing the NSF approved microcellular gasket to seal to the mounting surface. Door frame is hinged by aircraft cables and is supplied with captive stainless steel flush head screws to allow easy wiping of the surface. Available in 20Ga 304 Polished SS, or 18Ga Powder coated CRS.

GASKETS: NSF Listed closed cell microcellular extruded KleanLock SealPro gasket with vulcanized corners making a one-piece oil and solvent resistant gasket system.

LENS: Impact resistant .135" thick virgin acrylic with P12 prismatic pattern inverted. Sealed to door with NSF listed RTV silicone. See "Options" for other choices.

LAMPS: Suitable for most T5 and T5HO lamps. (By others)

ELECTRICAL: Standard Class P Ballast - Electronic < 10% THD, high performance rapid start universal voltage (120-277). See options for Dimming or Cold Temp Ballasts, Others available (must specify). Dual level switching available with 2/EB option

REFLECTOR: Die formed metal with high reflectance white polyester powder coat finish. Typical reflectivity 92%.

INSTALLATION: Fixtures are supplied with (4) .875" flattened and silicone sealed knockouts for wiring. Recessed housings are supplied with (6) swing out toggle arms. Housings fit most 1.0" and 1.5" Tbar grid ceilings, must verify with details below.

FINISH: Gloss white high reflectance 1000 hr. salt spray polyester powder coat finish standard for all recessed housings. Stainless steel doorframes are satin polished unless option WHT is chosen.

LISTINGS: IP66 rated for dust and water ingress. Suitable for 1700 PSI high pressure hosedowns. UL listed per UL_1598 for wet locations. Chicago Plenum Rated. Certified ISO-14644-1 for class 3 through class 9 cleanspaces. Certified Fed Std 209E for Class 1 through Class 100,000 cleanspaces. NSF2 Listed for Food Zones. Electrical components covered under manufacturers warranty, the remaining fixture is covered by a 10 year warranty.

PRODUCT DRAWINGS

PLENUM ACCESS REFERENCE DIMENSIONS							
SIZE	DIM A	DIM B	DIM C	DIM D	DIM E	DIM F	DIM G
2X4	46.90"	22.90"	47.63"	23.70"	46.6"	22.50"	4.00"

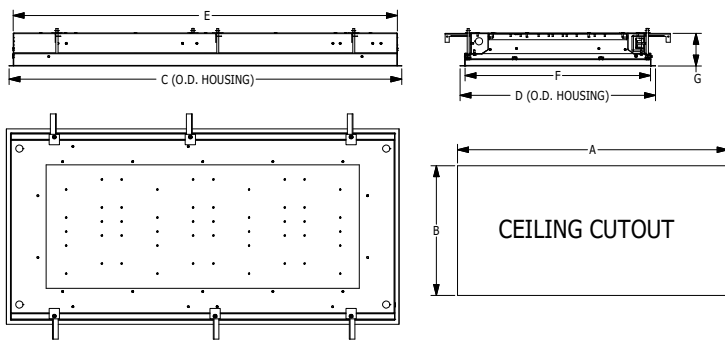

Grid Installation Detail

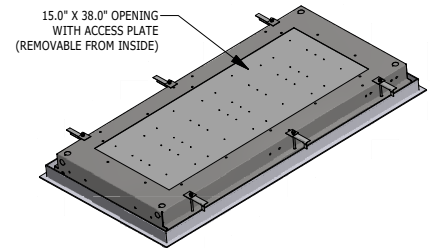

Flange Installation Detail

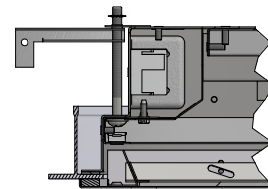
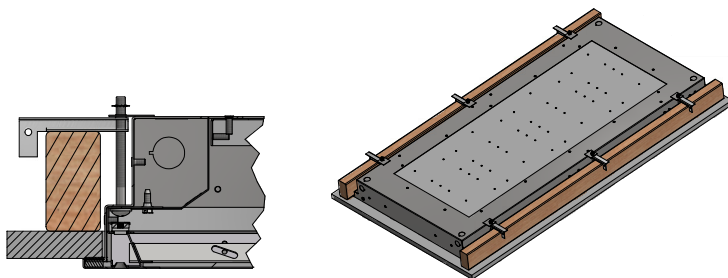

Cleanroom KL Plenum Access Troffers

2x4 Fluorescent Luminaire with Plenum Access

ENERGY DATA

PA OVERLAP-F-FLUOR TROFFER				
ENCLOSURE SIZE	LAMP TYPE	LAMP QTY ¹	(1/EM) 1 LAMP EMERGENCY ²	MAX AMBIENT TEMP ³
2X4	F28WT5	2,3,4, OR 6	1050 Lm	40°C (104°F)
2X4	F54WT5HO	2,3,4, OR 6	1150 Lm	40°C (104°F)

- 1 LAMPS SUPPLIED BY OTHERS
- 2 TOTAL GENERATED LUMENS (FROM STD EM BALLAST SPECIFICATION SHEET) HIGHER LUMEN OPTIONS MAY BE AVAILABLE
- 3 TEMP RATING MAY VARY WITH ALTERNATE SPECIFIED BALLASTS OR ANY NON STANDARD SELECTION