

DARKROOM SAFELIGHT INSTALLATION INSTRUCTIONS

Important Safeguards

When Installing Electrical Equipment, Basic Safety Precautions Must Always Be Followed, including the following:

Do Not Use This Product For Other Than Intended Use.

Caution: Installation Must Be Performed By Qualified Service Personnel.

Installation Shall be done in accordance with the wiring methods given in the NEC, NFPA 70 Art. 410, (as applicable)

Use of Accessory Equipment Not Recommended by the Manufacturer May Cause an Unsafe Condition.

Read and Follow All Instructional and Cautionary Labels Found On or In This Fixture.

Please note that this luminaire is intended for low level illumination. This product uses non-filtered narrow spectrum LEDs to achieve suitable emitted spectrums for the end use applications. Unless ordered or specified otherwise, each color will come with its own 0-10v dimming driver for field control of the spectral intensity.

Warning: Over illumination may harmfull to the end use application. Verify the light levels will not be harmfull and adjust intesity if required.

This product has an optional integral dimmer than can be ordered incase the luminaire is going into an area that does not have the ability to run new dimming control wires. If this option was ordered there will be a dimmer knob installed inside the fixture for light level comissioning This dimming knob will allow the light fixture to dim town to less than 3% of the published maximum illumination level.

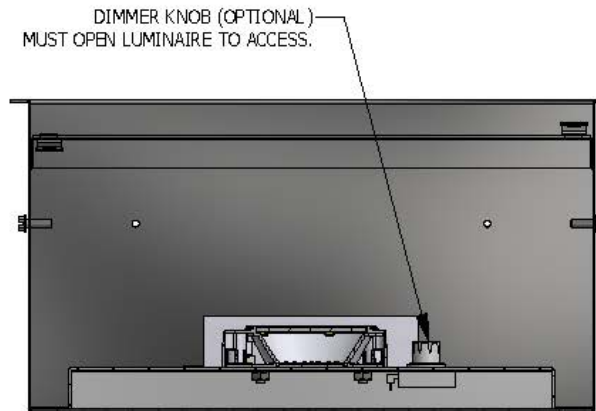
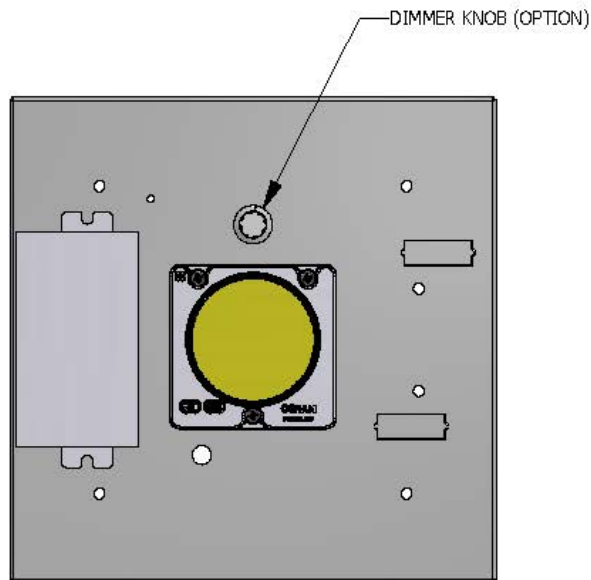

Kurtzon Lighting , Morris Kurtzon Inc., Chicago IL 60608

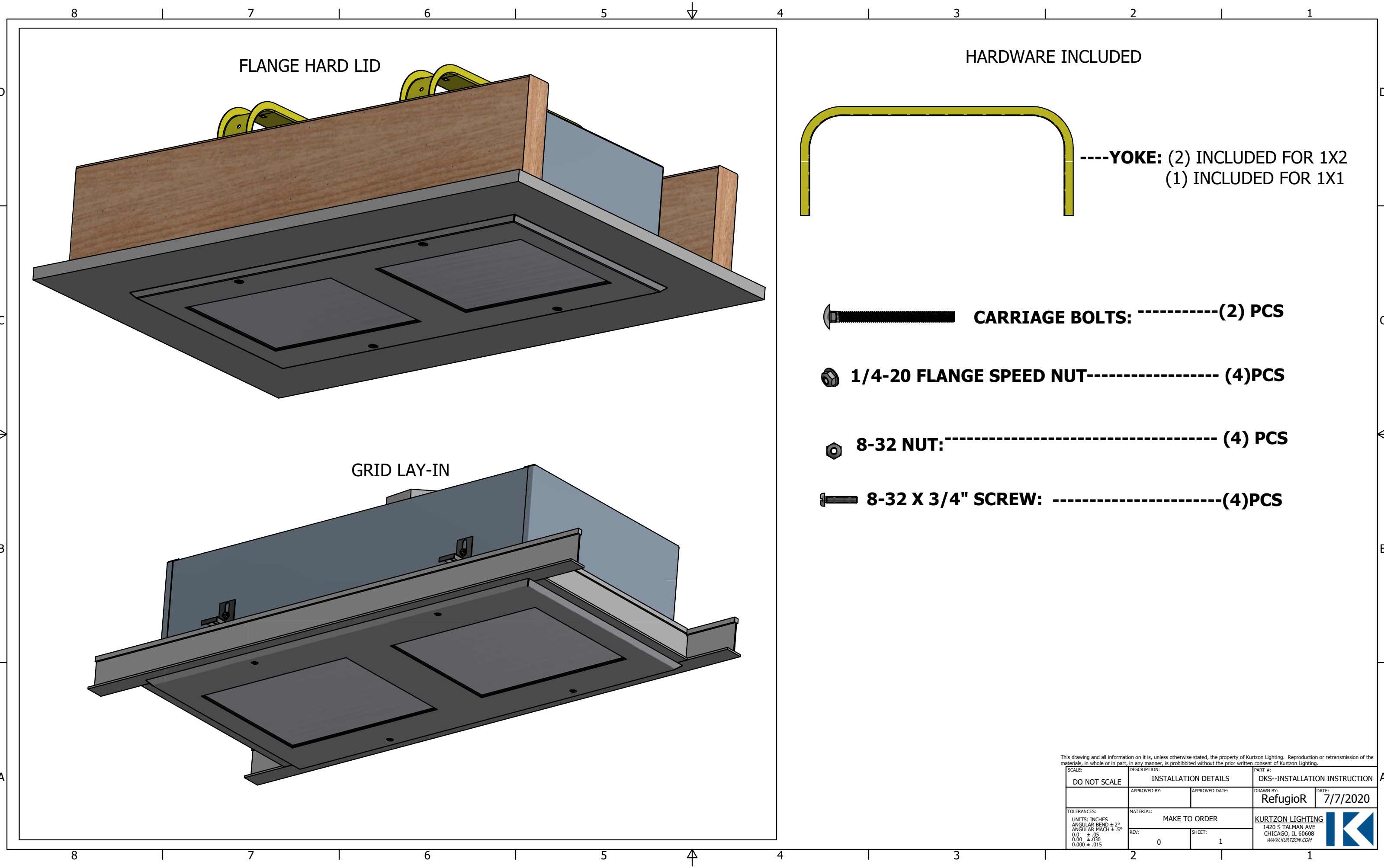

FOR FLANGE INSTALLATION

STEP 1: OPEN FIXTURE REMOVE INTERNAL REFLECTORS AND IDENTIFY CIRCUITS (EACH COMPARTMENT MAY HAVE UP TO 2 CIRCUITS)

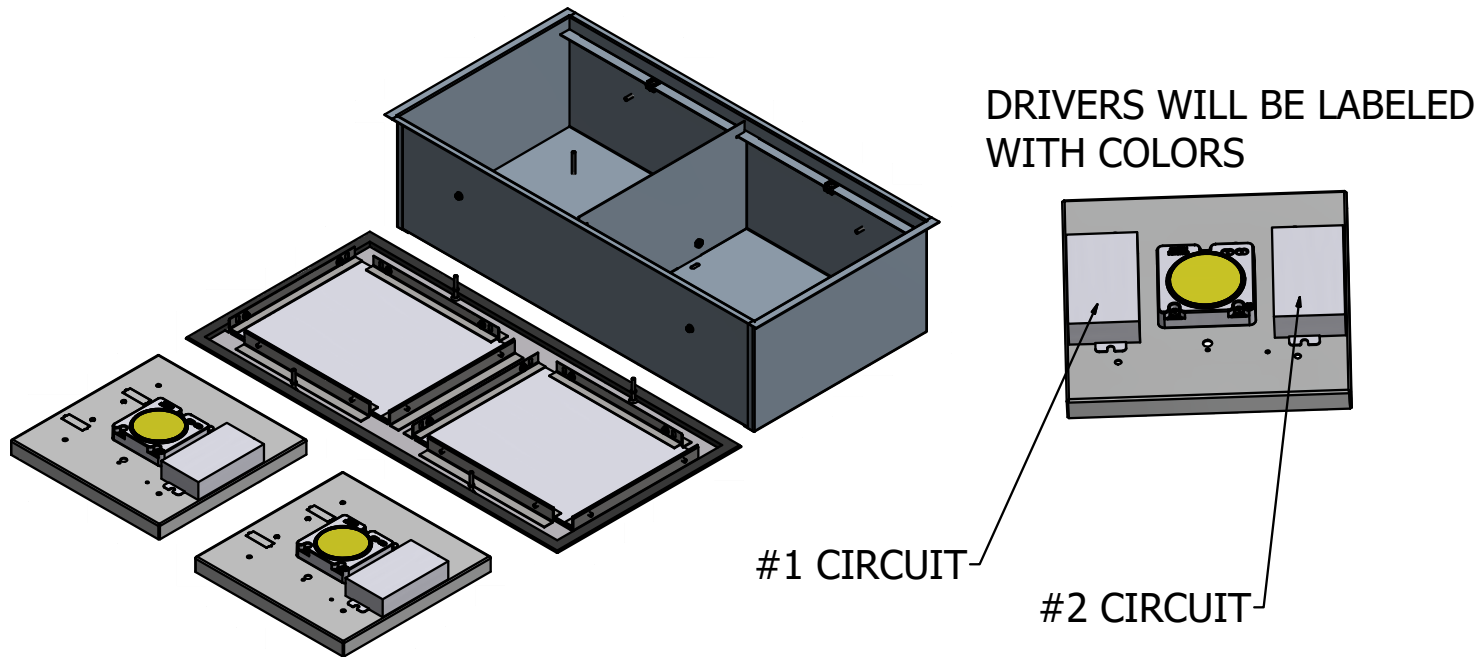

STEP 2: SELECT KNOCKOUT. MULTIPLE KNOCKOUTS MAY BY REQUIRED.

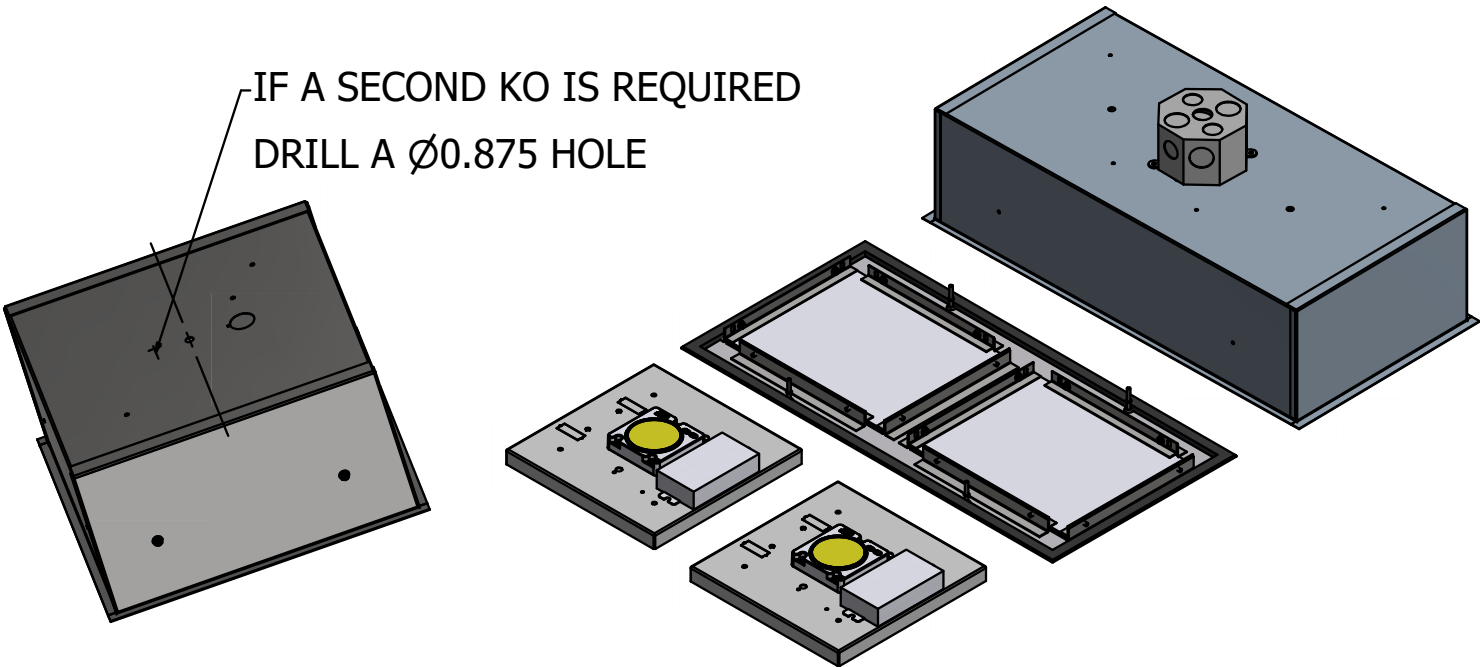

STEP 3: CUT HOLE IN CEILING

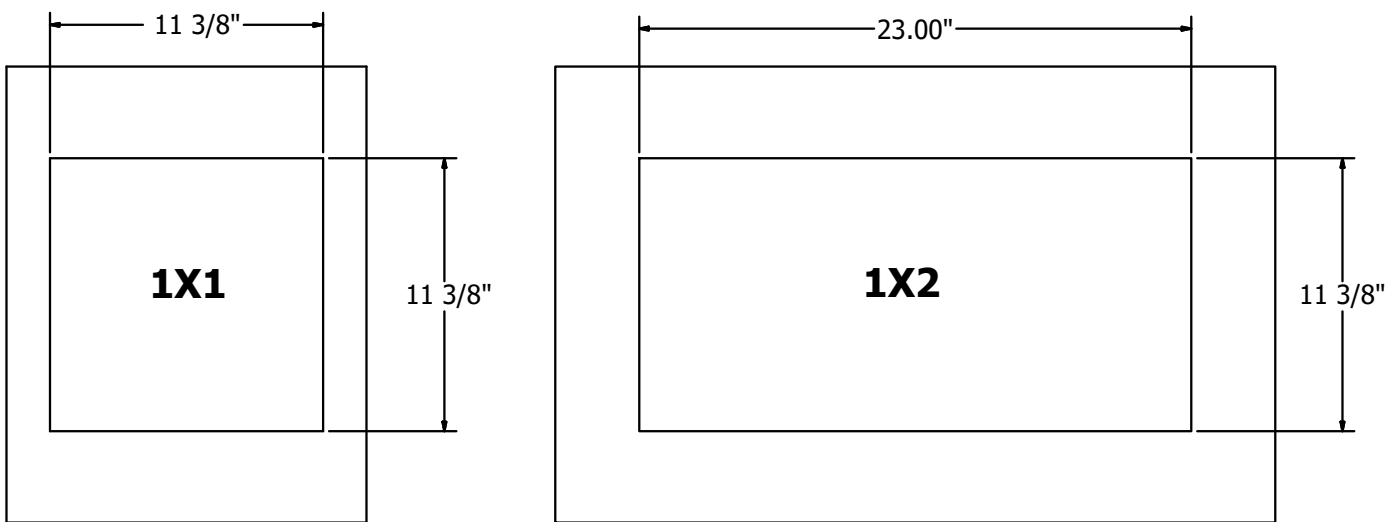

STEP: 4 REINFORCE AND INSTALL YOKES. (USE REFERENCE DIMENSION BELOW)

SECURE WITH APPLICABLE SCREWS (BY OTHERS) TWO ON EACH SIDE OF YOKE.

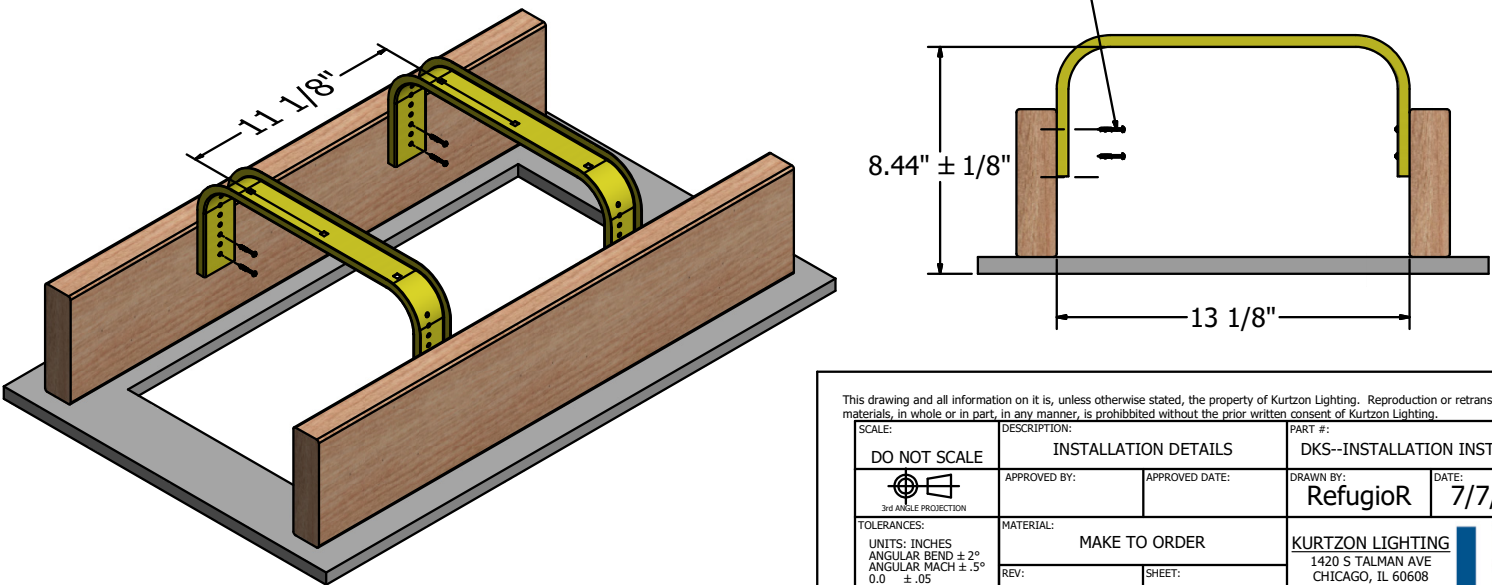

This drawing and all information on it, unless otherwise stated, the property of Kurtzon Lighting. Reproduction or retransmission of the materials, in whole or in part, in any manner, is prohibited without the prior written consent of Kurtzon Lighting.			
SCALE: DO NOT SCALE	DESCRIPTION: INSTALLATION DETAILS	PART #: DKS--INSTALLATION INSTRUCTION	
3rd ANGLE PROJECTION	APPROVED BY:	APPROVED DATE:	DRAWN BY: RefugioR
TOLERANCES: UNITS: INCHES ANGULAR BEND ± 2° ANGULAR MACH ± .5° 0.0 ± .05 0.00 ± .030 0.000 ± .015	MATERIAL: MAKE TO ORDER	SHEET: 2	DATE: 7/7/2020
REV: 0		KURTZON LIGHTING 1420 S TALMAN AVE CHICAGO, IL 60608 WWW.KURTZON.COM	

STEP 5: INSTALL YOKE HARDWARE

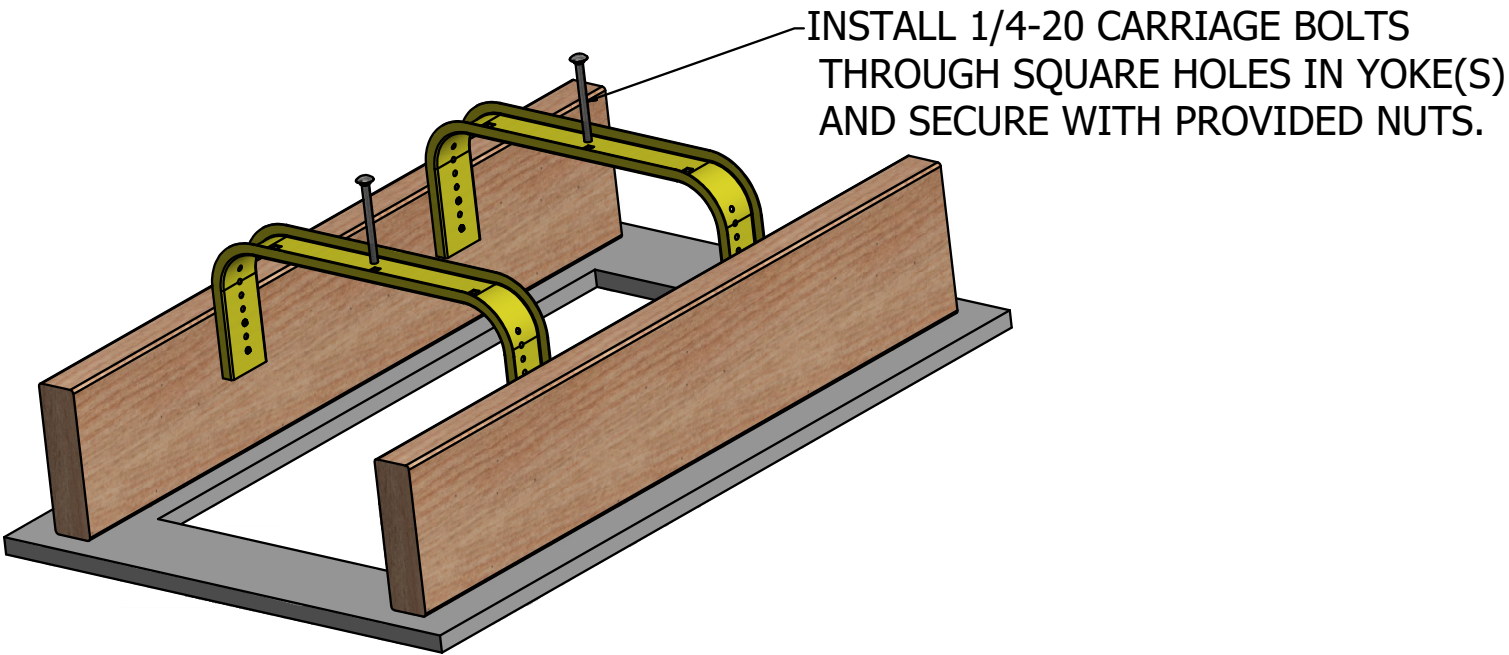

STEP 6: INSTALL FIXTURE

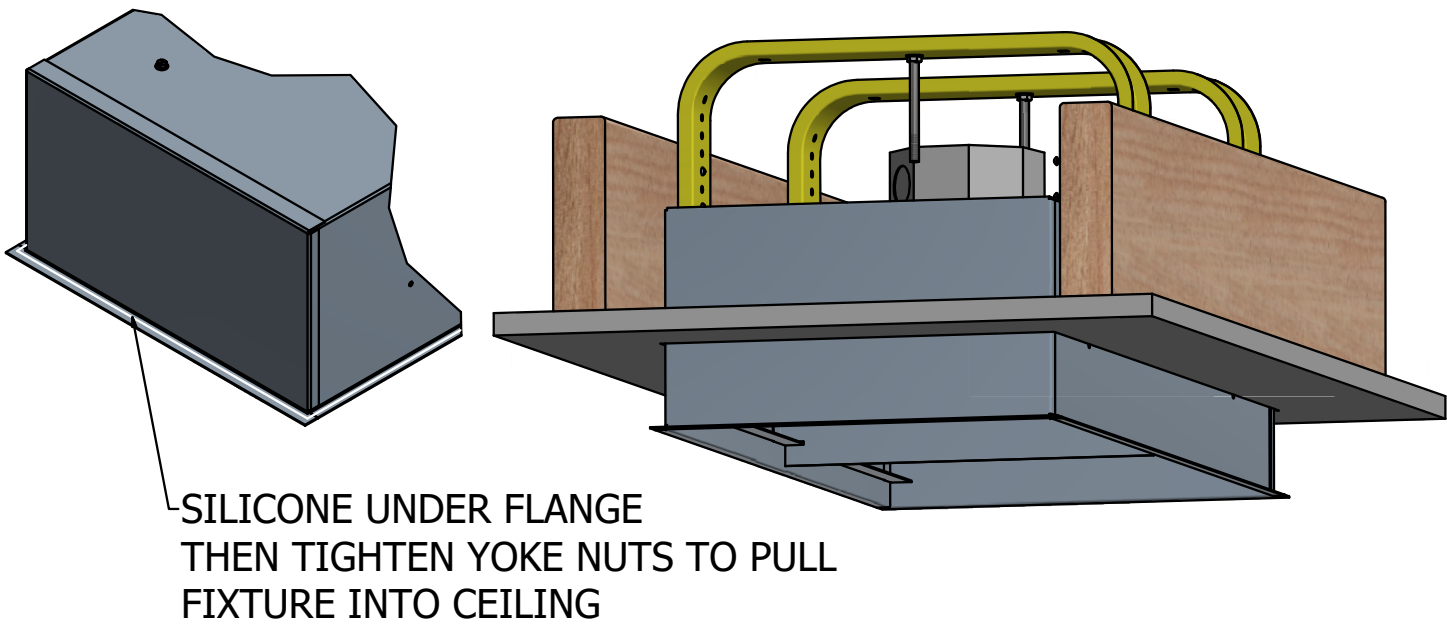

STEP 7: MAKE FINAL WIRING CONNECTIONS AND INSTALL LED PLATE

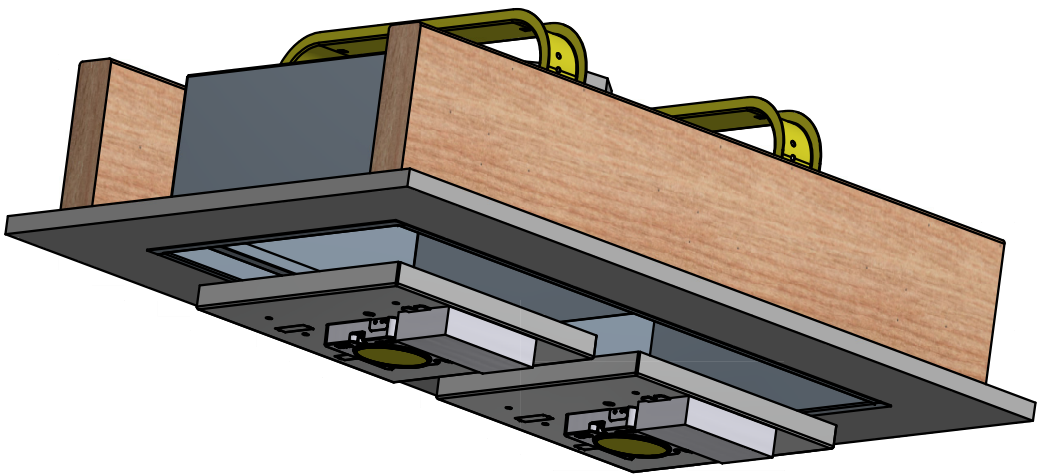

STEP 8: INSTALL DOOR FRAME

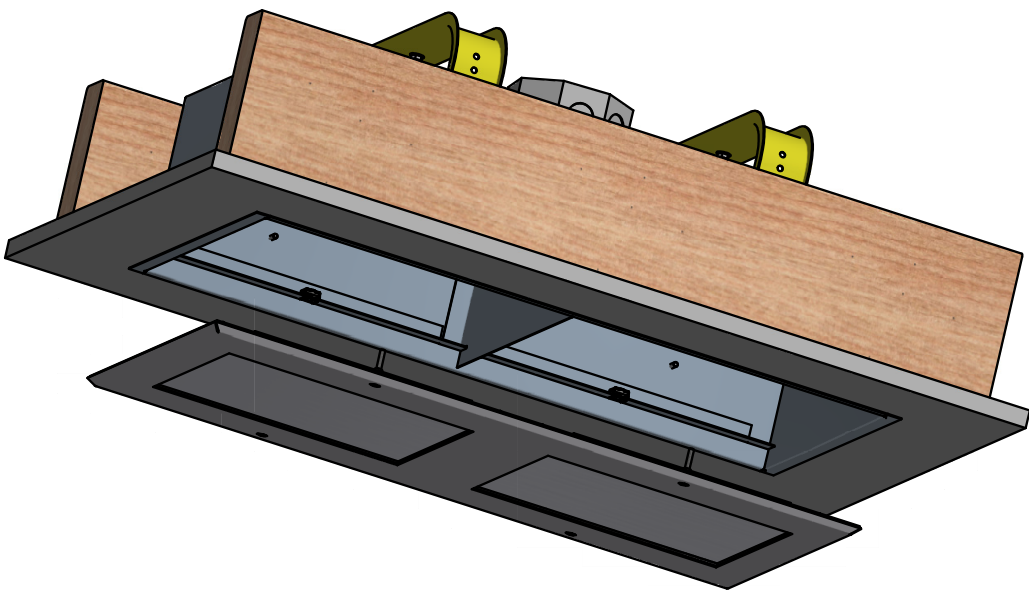

This drawing and all information on it is, unless otherwise stated, the property of Kurtzon Lighting. Reproduction or retransmission of the materials, in whole or in part, in any manner, is prohibited without the prior written consent of Kurtzon Lighting.

SCALE: DO NOT SCALE	DESCRIPTION: INSTALLATION DETAILS	PART #: DKS--INSTALLATION INSTRUCTION
	APPROVED BY:	APPROVED DATE:
	DRAWN BY: RefugioR	DATE: 7/7/2020
TOLERANCES: UNITS: INCHES ANGULAR BEND ± 2° ANGULAR MACH ± .5° 0.0 ± .05 0.00 ± .030 0.000 ± .015	MATERIAL: MAKE TO ORDER	KURTZON LIGHTING 1420 S TALMAN AVE CHICAGO, IL 60608 WWW.KURTZON.COM
REV: 0	SHEET: 3	

FOR GRID INSTALLATION, REPEAT STEP 1-2 FOM FLANGE INSTALLATION

STEP 3: PREPARE THE GRID FRAME
TYPICAL GRID OPENINGS BELOW.
VERIFY FIT USING REFERENCE DIMENSION ON
PRODUCT SPEC SHEET.

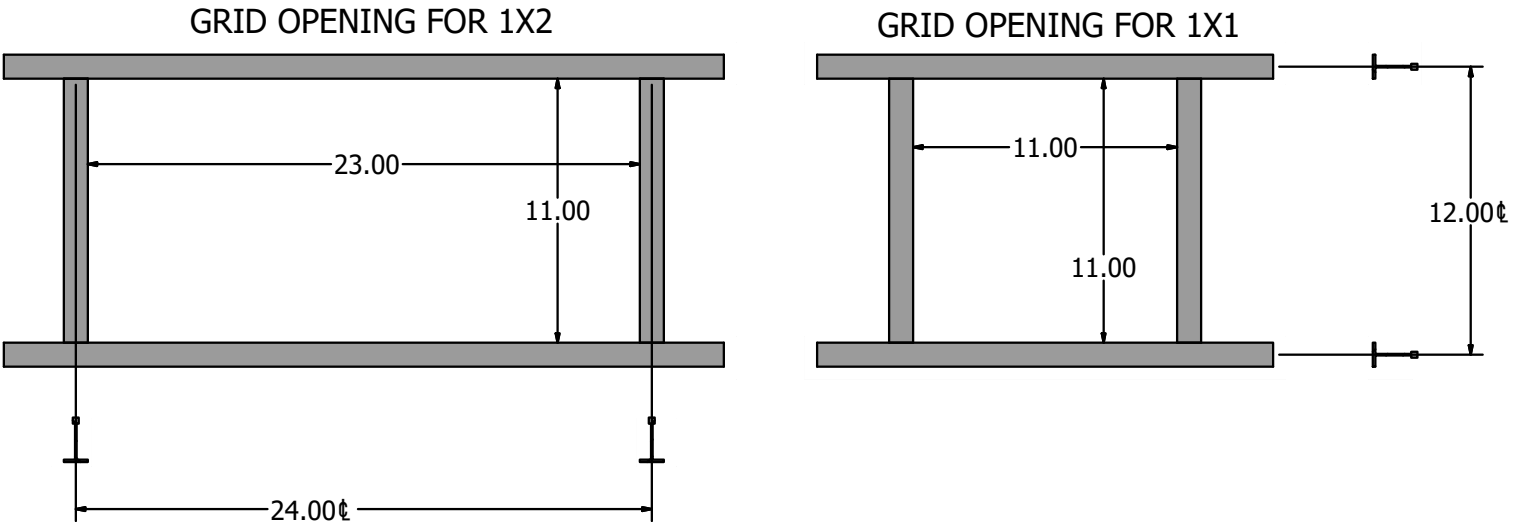

STEP 4: LAY THE FIXTURE INTO THE GRID AND ADJUST
BRACKETS TO SEAT ON GRID. THEN TIGHTEN THE SCREWS.

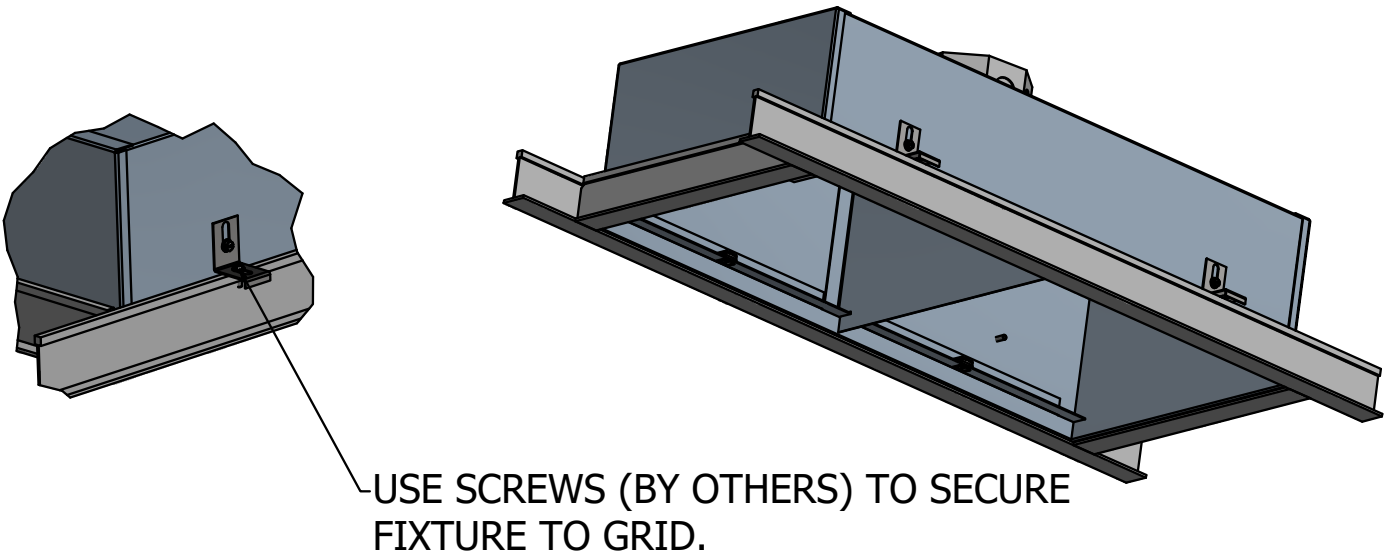

STEP 5: MAKE FINAL WIRING CONNECTIONS AND INSTALL LED PLATES

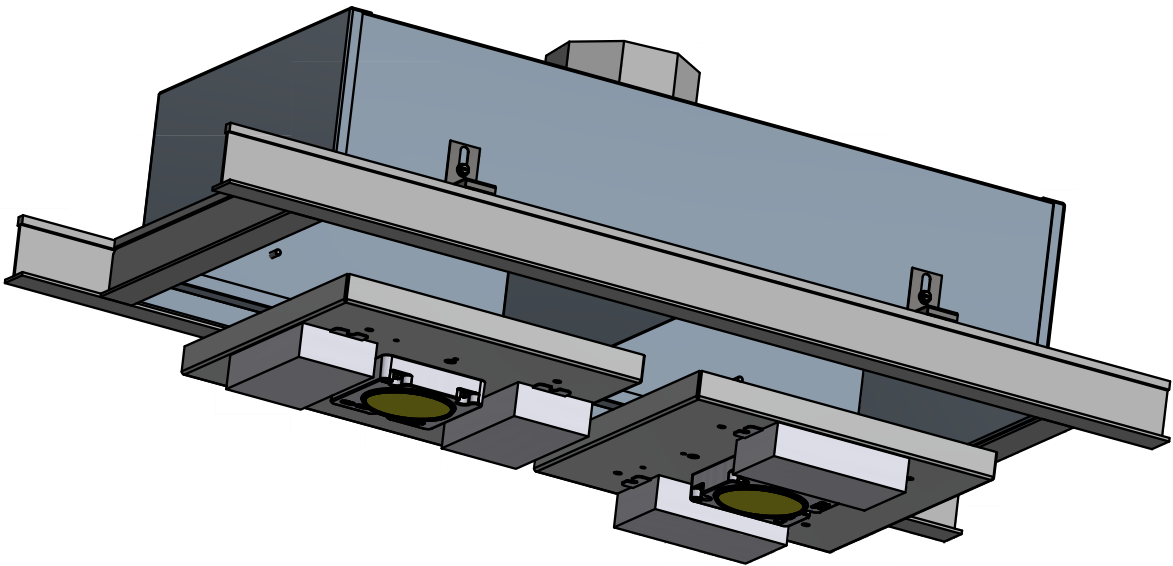

STEP 6: INSTALL DOOR FRAME

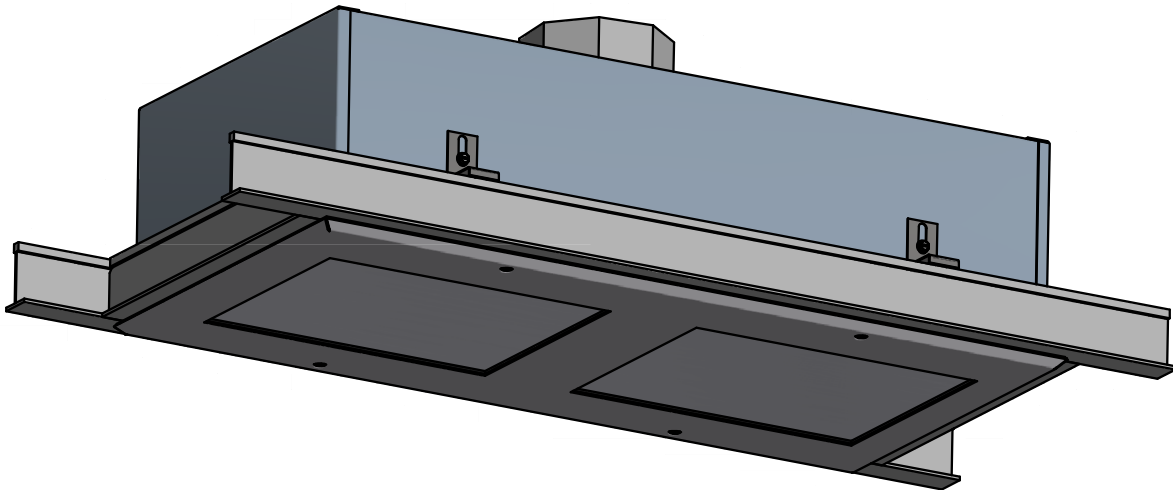

This drawing and all information on it is, unless otherwise stated, the property of Kurtzon Lighting. Reproduction or retransmission of the materials, in whole or in part, in any manner, is prohibited without the prior written consent of Kurtzon Lighting.					
SCALE:		DESCRIPTION:		PART #:	
DO NOT SCALE		INSTALLATION DETAILS		DKS--INSTALLATION INSTRUCTION	
APPROVED BY:		APPROVED DATE:		DRAWN BY:	
				RefugioR	
				DATE: 7/7/2020	
TOLERANCES:		MATERIAL:		KURTZON LIGHTING	
UNITS: INCHES		MAKE TO ORDER		1420 S TALMAN AVE	
ANGULAR BEND ± 2°				CHICAGO, IL 60608	
0.0 ± .05				WWW.KURTZON.COM	
0.00 ± .030		REV:		SHEET:	
0.000 ± .015		0		4	

FOR SURFACE INSTALLATION

STEP 1: OPEN FIXTURE REMOVE INTERNAL REFLECTORS AND IDENTIFY CIRCUITS (EACH COMPARTMENT MAY HAVE UP TO 2 CIRCUITS)

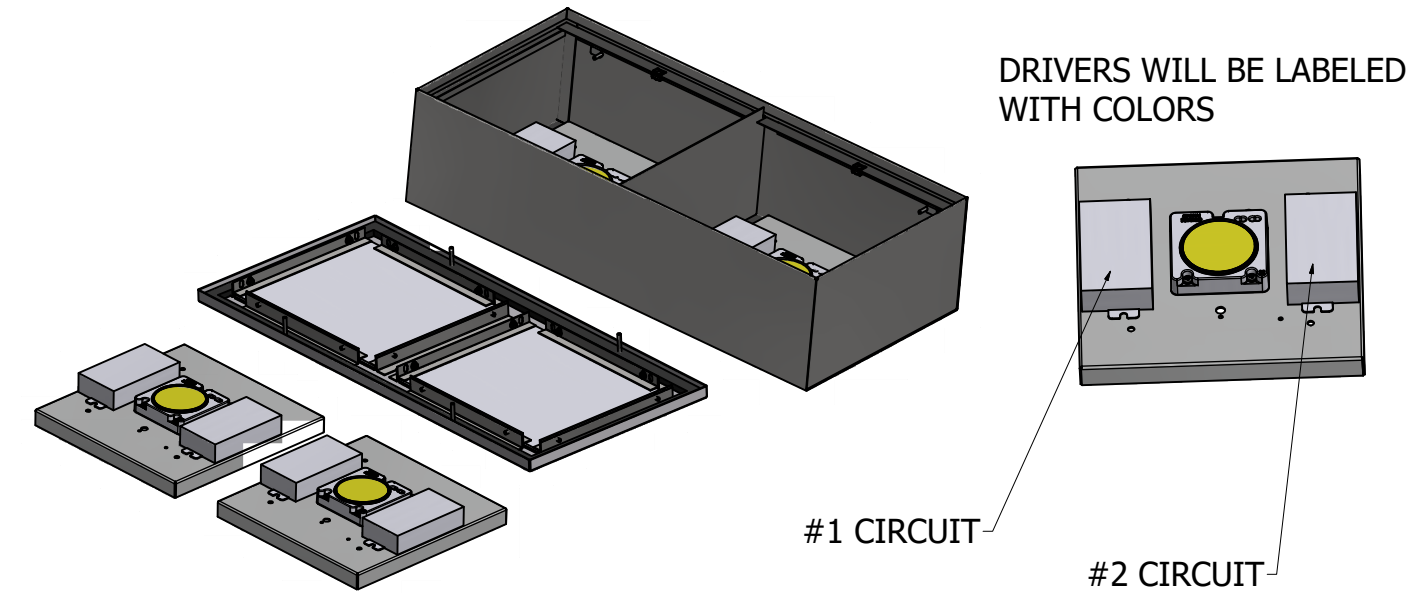

STEP 2: SELECT KNOCKOUT. MULTIPLE KNOCKOUTS MAY BY REQUIRED.

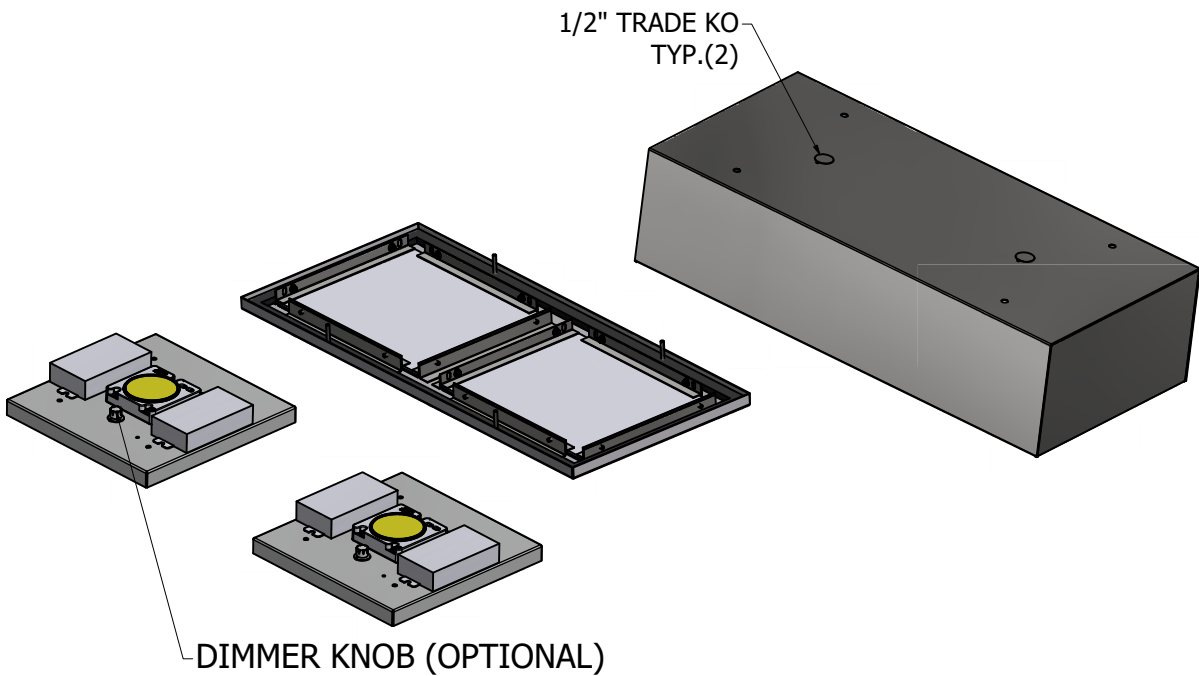

STEP 3: INSTALL FIXTURE IN CEILING (USE REFERENCE DIMENSION BELOW)

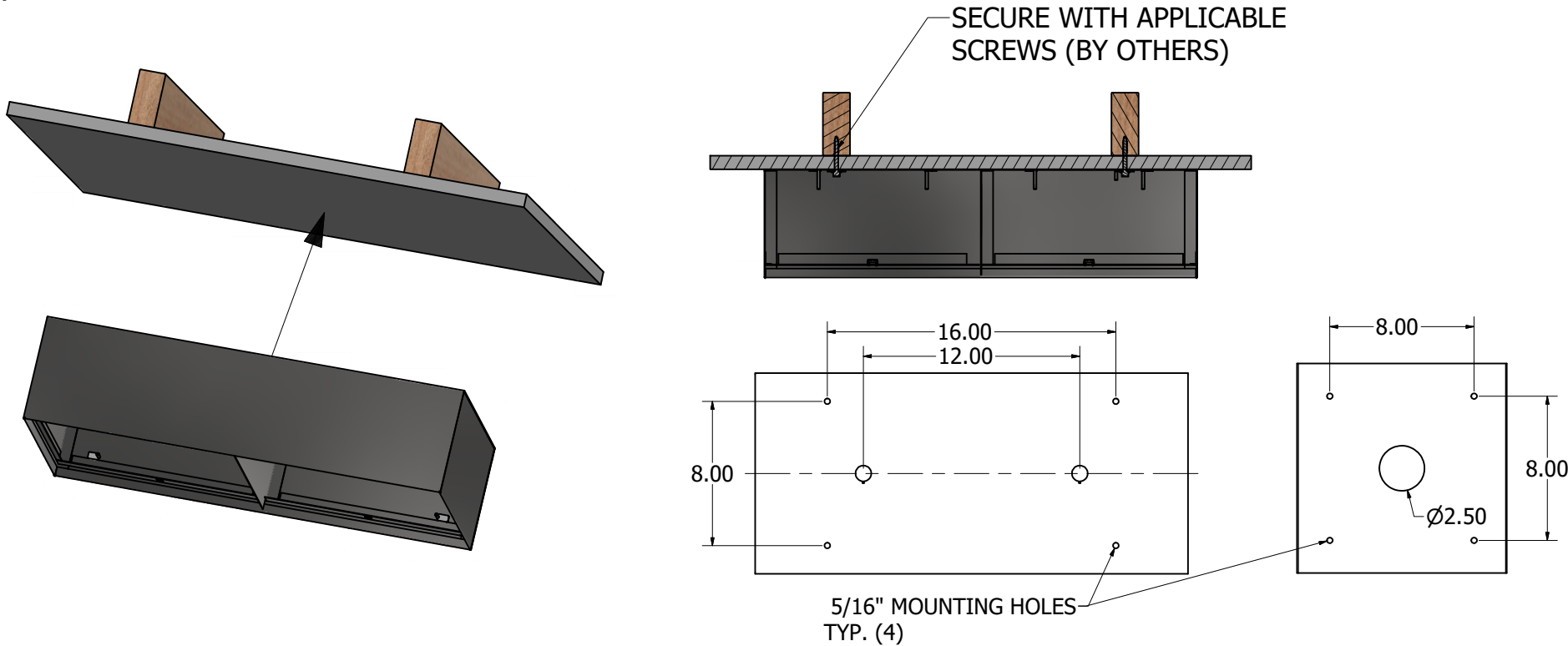

STEP 4: MAKE FINAL WIRING CONNECTIONS AND INSTALL LED PLATE

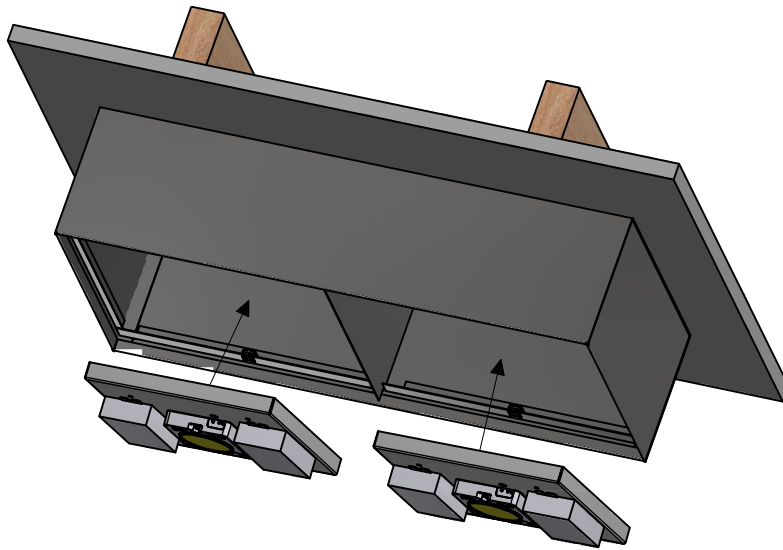

This drawing and all information on it, unless otherwise stated, the property of Kurtzon Lighting. Reproduction or retransmission of the materials, in whole or in part, in any manner, is prohibited without the prior written consent of Kurtzon Lighting.

SCALE: DO NOT SCALE	DESCRIPTION: INSTALLATION DETAILS	PART DKS-SURFACE-INSTALLATION INSTRUCTION
3rd ANGLE PROJECTION	APPROVED BY:	APPROVED DATE:
TOLERANCES: UNITS: INCHES ANGULAR BEND ± 2° ANGULAR MACH ± .5° 0.0 ± .05 0.00 ± .030 0.000 ± .015	MATERIAL: MAKE TO ORDER	DRAWN BY: refugior
	REV: 0	SHEET: 1
		DATE: 7/7/2020
		KURTZON LIGHTING 1420 S TALMAN AVE CHICAGO, IL 60608 WWW.KURTZON.COM

STEP 5: INSTALL DOOR FRAME

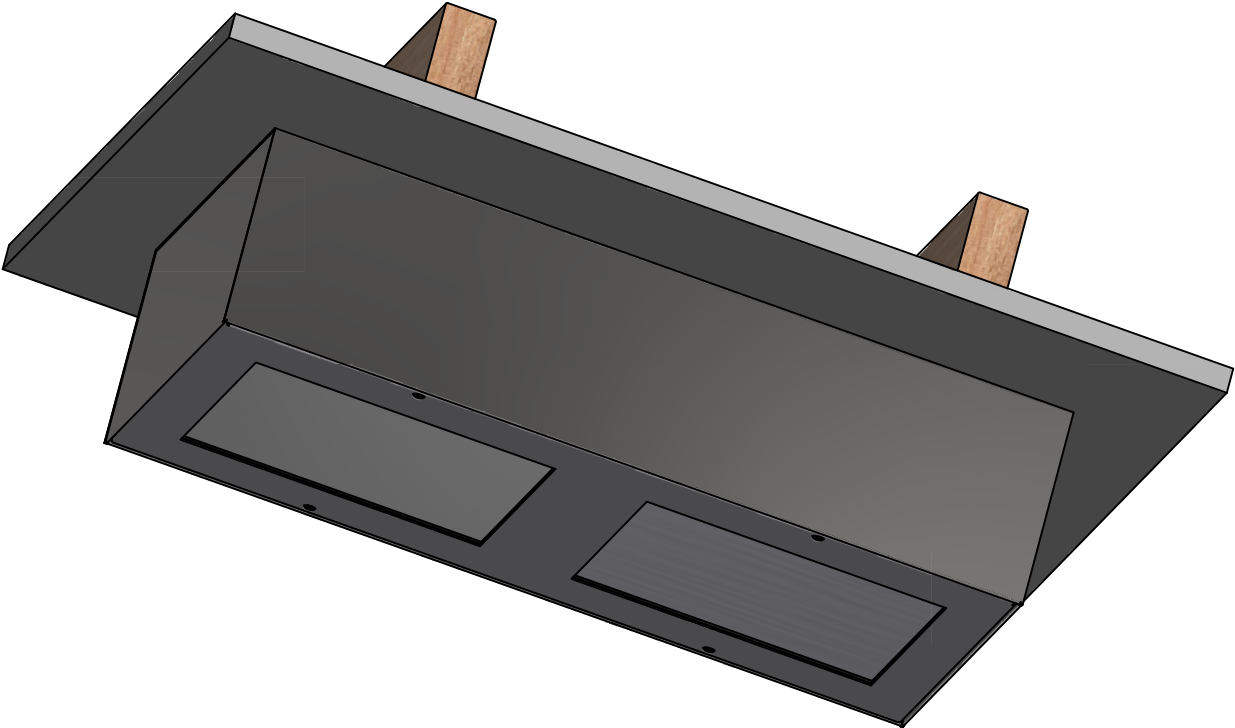
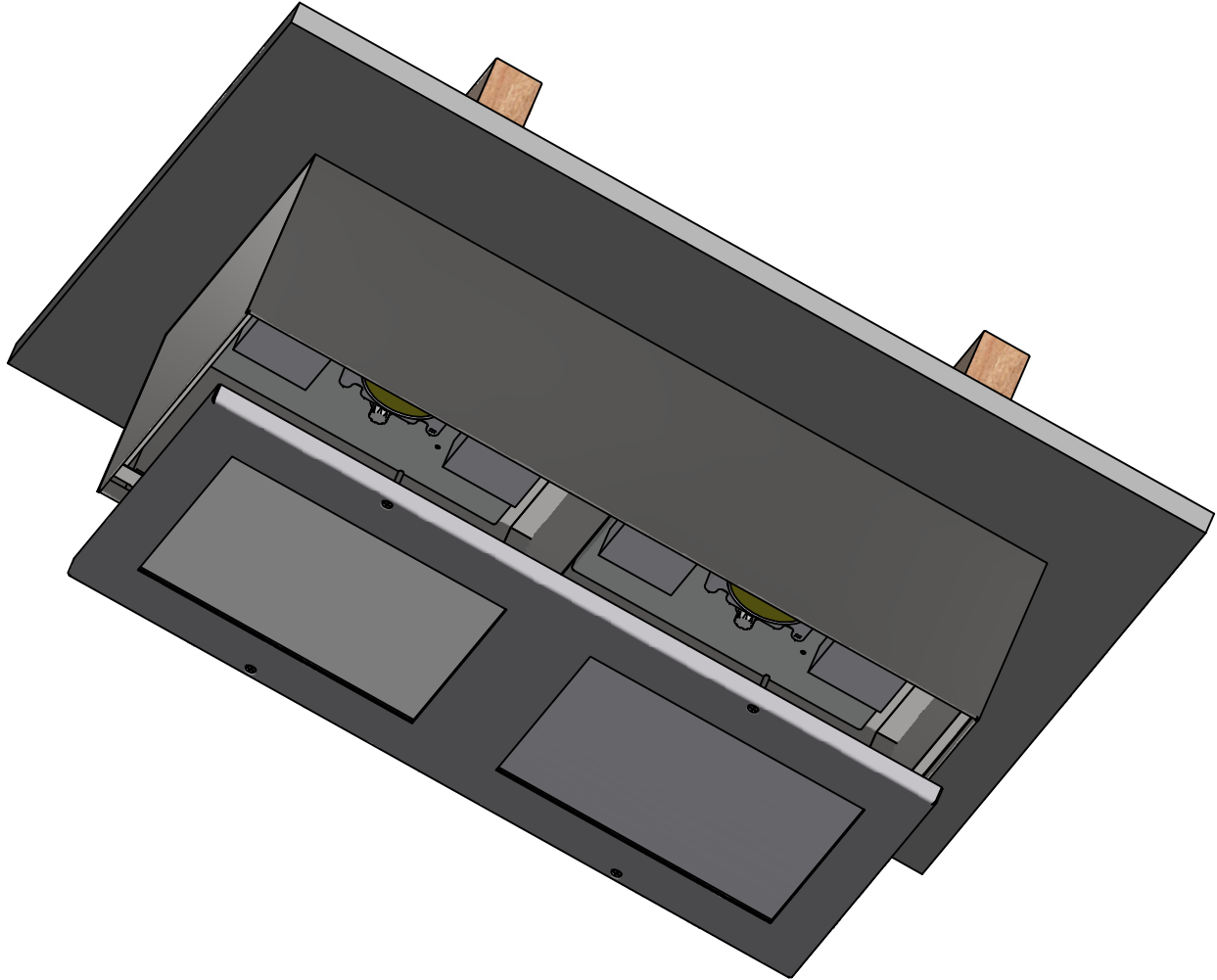

This drawing and all information on it is, unless otherwise stated, the property of Kurtzon Lighting. Reproduction or retransmission of the materials, in whole or in part, in any manner, is prohibited without the prior written consent of Kurtzon Lighting.					
SCALE:	DESCRIPTION:		PART #:		
DO NOT SCALE	INSTALLATION DETAILS		DKS--SURFACE-INSTALLATION INSTRUCTION		
	APPROVED BY:	APPROVED DATE:	DRAWN BY:	DATE:	
			RefugioR	7/7/2020	
TOLERANCES:	MATERIAL:		KURTZON LIGHTING		
UNITS: INCHES	MAKE TO ORDER		1420 S TALMAN AVE		
ANGULAR BEND ± 2°	REV:	SHEET:	CHICAGO, IL 60608		
0.0 ± .05	0	2	WWW.KURTZON.COM		
0.00 ± .030					
0.000 ± .015					

